

SPOTTING TABLE
GB-S COMPACT



USER'S AND MAINTENANCE MANUAL

INDEX

01 - SAFETY NOTICES	3
02 - GENERAL DESCRIPTION AND INTENDED USE	3
03 - EQUIPMENT IDENTIFICATION	3
04 - TECHNICAL FEATURES	4
05 - IDENTIFICATION OF MAIN COMPONENTS	4
06 - PRECAUTION	4
07 - INSTRUCTIONS FOR USE	5
08 - HANDLING AND TRANSPORT	6
09 - MACHINE UNPACKING AND INSTALLATION	6
10 - TROUBLESHOOTING AND SOLVING	7
11 - DISPOSAL	7
12 - HOW TO ORDER SPARE PARTS	8
13 - OVERALL DIMENSIONS AND DRAWINGS.....	9
14 - WARRANTY	9

01 - SAFETY NOTICES

This user manual and maintenance refers to the product: spotting table GB-S COMPACT

It is possible to request the latest release to our Technical Commercial Department or by visiting our website www.ghidini-gb.it.

The present user's and maintenance manual contains important information for the operator's health safeguard and safety.

Read completely this manual with attention and strictly follow the procedures described in it before installing the equipment and starting it up. Keep this manual carefully and always at the disposal of the product operating personnel.

The manual contains the following graphic symbols that identify clearly important warnings and safety notices:



WARNING!



PROHIBITED!



WARNING! ELECTRICAL PARTS
UNDER VOLTAGE



PROHIBITED TO WALK
OR USE AS SUPPORT



WARNING! PRESSURIZED GAS
PIPELINES



KEEP THE EQUIPMENT
AWAY FROM CHILDREN

Failing to follow the indications in this manual could forfeit personnel safety!



Any possible modifications effected on the components of the machine or its different use without prior written authorization by Ghidini s.r.l., relieve the latter of injury to persons and / or damages to things, voiding any warranty bindings, as well.
Ghidini s.r.l. cannot be held liable for any damage to things or injury to persons caused by improper use of the machine in contrast with these instructions

02 - GENERAL DESCRIPTION AND INTENDED USE

Compact cold spotting table:

- Stainless steel AISI 304 board
- Complete with two cold spotting guns with independent circuits and two tanks for solvents
- Built-in vacuum unit (single phase)
- Air gun

This equipment is intended for professional use and aimed at professionals and skilled workers.



Keep the equipment in every state (still packaged, off, running, etc.) away from children and unskilled.

03 - EQUIPMENT IDENTIFICATION

On the side of the machine is placed an identification plate on which there is:

- Model
- Serial number
- year of construction.
- Supply voltage
- Electrical power consumption.
- Supply pressures.

04 - TECHNICAL FEATURES

TECHNICAL FEATURES	
Required power	230Vac 1~ 50-60Hz
Air inlet	1/4" Gas
Air consumption	30 NI/min.
Air working pressure	6 ÷ 8 bar
Vacuum motor	100 W
Board dimensions	400 x 200 x 35 mm
Encumbrance	640 x 320 x 325/680h
Net weight	12,7 kg
Gross weight	14 kg
Overall dimensions (packaging included)	650 x 330 x 335 mm
Volume	0,07 m3



WARNING:

The machine must not be supplied with different voltages than those indicated on the identification plate.

05 - IDENTIFICATION OF MAIN COMPONENTS

01 – PLASTIC TANK FOR SOLVENTS

02 – SPOTTING GUNS

03 – AIR GUN

04 – POWER SWITCH

05 – TABLE POINT NET

06 – VACUUM PEDAL

07 – COLLECTING TANK FOR SOLVENTS

08 – TROLLEY (OPTION)

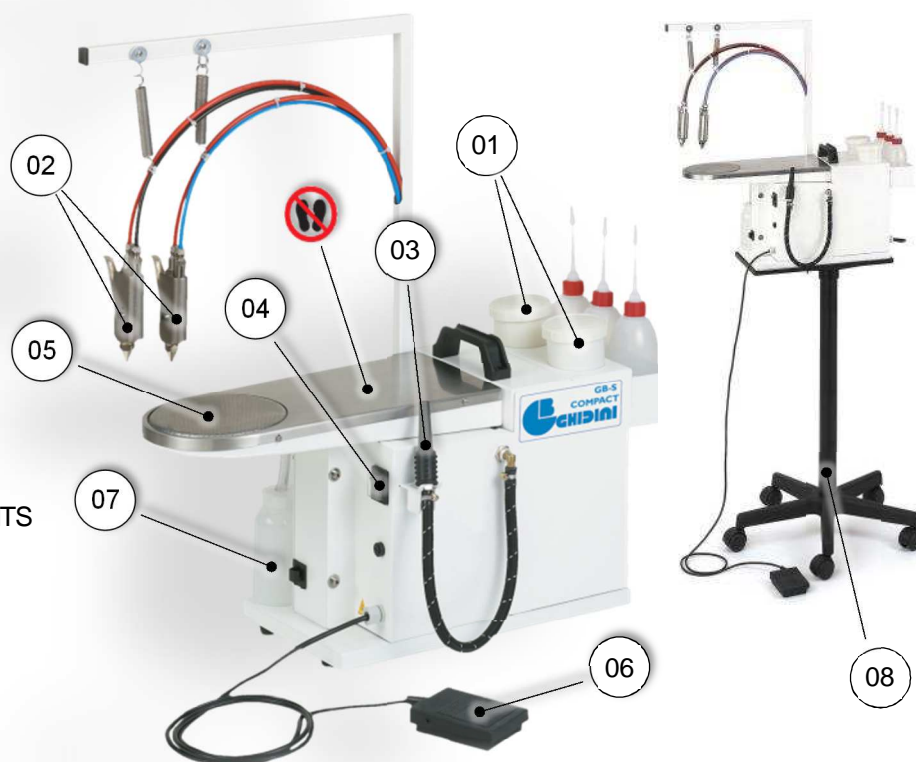

06 - PRECAUTION

Read carefully the instructions and the risks related to the use of an ironing table. The operator has to know its working functions and must clearly understand its dangers with the help of the manual.



Main electrical supply

Prior to carrying out any inspection or service on the machine, it is necessary to disconnect it from the main electrical supply. Make sure, that nobody can reconnect it during the technical service.

Every installed electrical or electronic equipment must be earthed.



Inflammability

Adopt all the necessary precautions to avoid any direct contact of the machine with hot materials or flames. Put fire extinguishers near the machine for an immediate intervention in event of fire.



Pressure / Compressed air

Before each intervention check that residual pressures are not inside every single branch of the pneumatic circuit.

Noise

The noise emission is not excessive, because it remains under 70dB(A).

07 - INSTRUCTIONS FOR USE

PUTTING INTO OPERATION



The whole unit can be used, opened and repaired by qualified technicians only.

It is forbidden to use the machine if flooded by liquids or in particularly aggressive or explosive/inflammable places.

Always use suitable pipes according to the working pressure.

Do not ignore the dangers for the operator's health and follow the hygienic and safety regulations.

Check that the electrical wiring is carried out correctly according to the current regulations, and that the fuse blocks are closed and complete of fuses.

Make sure that the machine is intact.

USE



WARNING: The first use of the equipment after installation or maintenance must be done on a trial basis and regulation of all parts and accessories using tissues or garments not important. Some parts of the machine may leave halos or spots as used for the first time. This situation may also not occur but is not a fault.

Turning on.

Turn on the main micro-switch placed on the power supply line and that one of the machine.

Fill the tanks of the spotting table with the solvents.

Open the gate valve of the compressed air.

USE OF THE TABLE

In the working position, with the table point on the left, put the part of the garment which is to be treated on the table point (on the part with the grid). Once the vacuum pedal is pushed, the garment attaches itself firmly to the table point, caused by the sucked-in air.

USE OF THE SPOTTING DEVICE

Put the garment, which is to be treated, on the table or on the shape, taking care that the stain lies on the sucking surface. Operate the vacuum pedal, the garment attaches itself firmly to the supporting part, caused by the sucked-in air. Approach the spotting gun approximately up to 1cm from the stain, which is to be treated and press the lever entirely down. The mixture of air and solvent at this distance is able to remove every kind of particle clinging to the textile-fibres. The spotting gun can also be used for the drying process, by pressing the handle half down you obtain in this way only the air-outlet.

ADVISE FOR THE TREATMENT OF PARTICULAR STAINS

Grease stains:

Put on the part to be treated as previously described, taking care of laying a cloth between the supporting surface and the garment.

Treat the stain with the most suitable solvent against the type of grease in question, push the vacuum pedal and brush simultaneously. The vacuum operation favours the removing of the solvent and of the stain, avoiding the forming of halos.

Varnish stains:

Pre-treat the stain with the suitable solvent joining the mechanical operation of a steel or a hard bristle brush.

After having dissolved the stain, go over to the spotting table and put the part on the vacuum surface, afterwards push the vacuum pedal.

Wet the stain with a soaked sponge or with the water spray gun, if the table is equipped with this option.

The concentrated and substantial vacuum removes the stain and the solvent.



WARNING: DURING OPERATION, DO NOT EVER:

Leave the equipment operating unchecked, not even for a short period, otherwise turn it off.

08 - HANDLING AND TRANSPORT

Before its shipment, the machine is carefully packed in a carton box or in a wooden frame. During the shipment and storing of the machine, pay particular attention to the upside indication on the packaging. Upon receipt, please check that the packing is intact and store the machine in a dry place.

09 - MACHINE UNPACKING AND INSTALLATION



ATTENTION: The unit must be installed, opened and repaired by fully qualified technicians only.

If the unit has been damaged externally during transport, may have suffered internal damage to its components. Check the integrity of the machine before installation.

UNPACKING:

Find the most suitable place where to put the machine, then remove the packaging. Make sure that the machine has not been damaged during the transport and the storage.

The packaging material does not require any special precautions for its disposal, for it is not dangerous or polluting at all. Please refer to the local regulations for its disposal.

INSTALLATION:

The machine does not need to be anchored to the floor, except for installation on self-moving means, where it is necessary to use the holes on the base for the right fixing.



For a correct use and operation, as well as for an easy maintenance, leave a free space around the machine



Do not install the machine in dangerous and/or inflammable places and/or unsuitable places.

Do not install the equipment on a inclined pavement or on unstable supports interposed between the machine and the floor, danger of overturning.



Do not step on and not to use the equipment and its work plans as a ladder to reach the high points, and generally do not use it as a support tool. Risk of damage and injury.

ELECTRICAL WIRING:

Check that the supply voltage and the frequency correspond to those indicated on the rating plate before connect the machine to the electrical supply. It is advisable to install a switch with fuses or a magnetothermal one.

After all the connections to make sure that the power cables are properly secured and protected from shocks and from contact with hot and/or sharp surfaces.

COMPRESSED AIR CONNECTION

From the central compressed air supply divert a 1/4" Gas piping and install a gate valve and a pressure reducer in correspondance to the machine, connect a tube of an internal diameter not inferior to 6 mm to the filter of the spotting table.

Regulate the reducer to the desired pressure, maximum 10 bar.

Close the gate at the end of the work in order that the semi-automatic exhaust valve, placed below the filter bucket, can be opened and discharge all the condensate deposits.

10 - TROUBLESHOOTING AND SOLVING

If the performance of the spotting gun should diminish, proceed with the cleaning of the filter situated below the junction of the solvent inlet and control the nozzle passage, dismounting the cap of the gun.

The filter of the compressed air situated on the machine is equipped with a semi-automatic valve for the condensate exhaust, which opens whenever the equipment is not under pressure anymore.

Be reminded therefore to close every evening the air inlet, so that the valve can empty the filter of all the deposited impurities.

If the utilisation of the machine should last for several hours during the whole day, control periodically the filter in order to avoid that the bucket is filled up too much, so that the condensate cannot be held back anymore reaching therefore the garment which is to be treated and risking in this way to damage it irrevocably.

Clean periodically, even with the help of a brush, the net of the table point and that one of the spotting shape.

The vacuum motor does not work:

- Control if the micro switch on the vacuum pedal works correctly, if defective, substitute it.
- Control on the single phase motors if the condenser is defective, substitute it by a qualified technician.
- The motor is burnt, it must be substituted by a qualified technician.

Loss of air from the air circuit:

These losses can depend on the bad tightness of some junctions. Control every junction with soapy water and re-establish the correct tightness.

11 - DISPOSAL

During the maintenance on the machine, or in case of its scrapping, please dispose carefully and correctly of any polluting components, according to the local regulations. In case of scrapping, the identification rating plate and any other document have to be destroyed.

12 - HOW TO ORDER SPARE PARTS

Upon the spare parts request, please quote always:

Machine type, serial number, quantity of the requested spare parts, article number (these data can be read on the rating plate or supplied by the technical information of the machine and by the user's and maintenance manual). For electrical components with a different voltage and frequency than V 230-400 50Hz (data available on the rating plate of the faulty component), specify the right voltage and frequency after having mentioned the article number. The technical data, the descriptions and pictures included in this manual are not binding. The manufacturer reserves the right to make any necessary modification without notice or having to up-date the present manual.

The following are the main machine components:

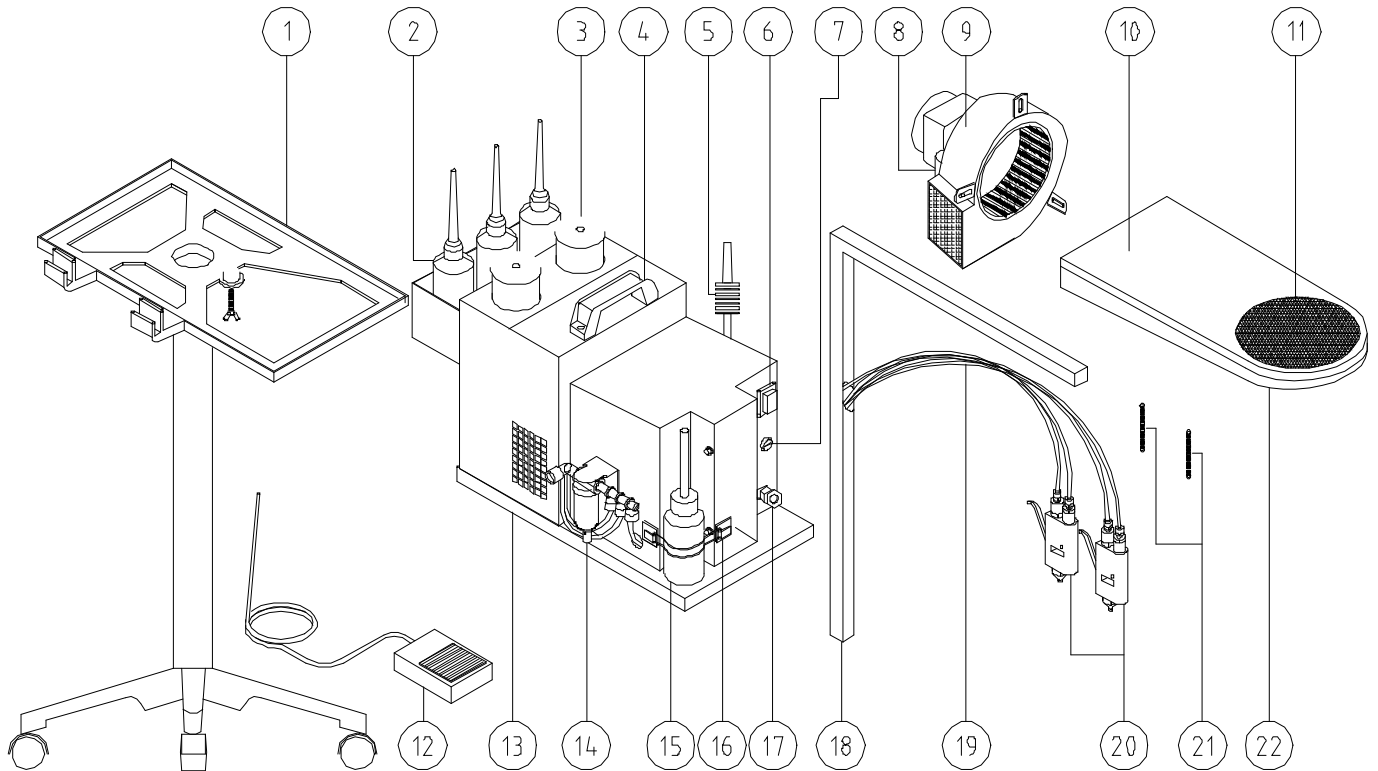

Pos.	COD.	DESCRIPTION	Pos.	COD.	DESCRIPTION
1	Z27A00	Trolley	13		
2	260022	Plastic tank for solvents	14	35B006	Air-filter bucket
3	Z19P03	Plastic tank for solvents	15	260021	Collecting tank for solvents
4	523260	Handle	16		
5	Z07F03	Gun	17	46C017	Electrical inlet PG 9
6	43A020	Switch	18	172406	Antenna
7	43F033	Fuse	19	06D006	Tube Ø 6x4
8	-	Capacitor	20		Spotting guns
9	Z25H02	Vacuum motor V230-50/60Hz	21	534258	Spring
10	172403	Board plate	22	172405	Board
11	173109	Table point net	23		
12	43B009	Vacuum pedal	24		

13 - OVERALL DIMENSIONS AND DRAWINGS

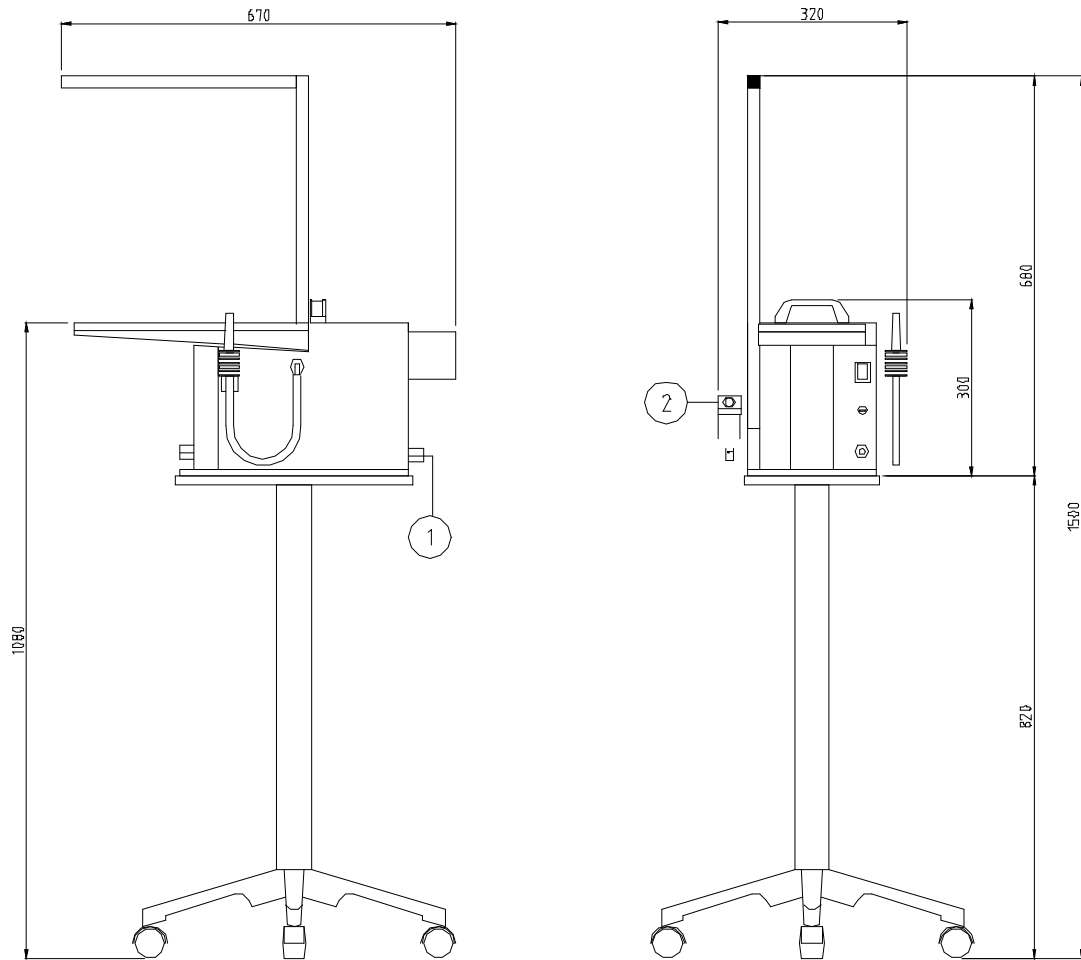

14 - WARRANTY

All Ghidini products are guaranteed for a maximum period of 12 months from delivery date as far as material and construction defects are concerned.



The warranty is extended as follows:

In case of malfunction of the equipment, please contact your Ghidini reseller, specifying the noticed defect, type, serial number and furthermore the operating conditions of the machine. After having received the equipment or component and after an accurate analysis, Ghidini reserves the right to repair or to replace the product. If the machine is still under guarantee, the Ghidini reseller will carry out the service or replacement at Ghidini's charge. In case the returned goods are not defective, Ghidini reserve the right to charge the customer with the met expenses (shipment, etc.). The present warranty will be declared void, if the machine has been damaged due to improper use, negligence, normal wear, chemical corrosion, installation not according to the provided instructions and to the manufacturer's warnings. Any modification, tampering and alteration on the machine or its components, carried out without prior written authorization by Ghidini, relieve the latter of any responsibility and annul any warranty obligation. The components subject to normal wear and the perishable ones are not under warranty, as well as everything which has not been previously explicitly indicated, or damages or expenses arising from defects of the same product. The validity conditions of the guarantee provided by Ghidini are considered implicitly accepted upon purchase of the machine. Any possible changes to or derogations from the present guarantee are only valid prior written authorization by Ghidini.



Web site: <http://www.ghidini-gb.it> - E-mail: sales@ghidini-gb.it