

# GLOBAL

## PARTS BOOK

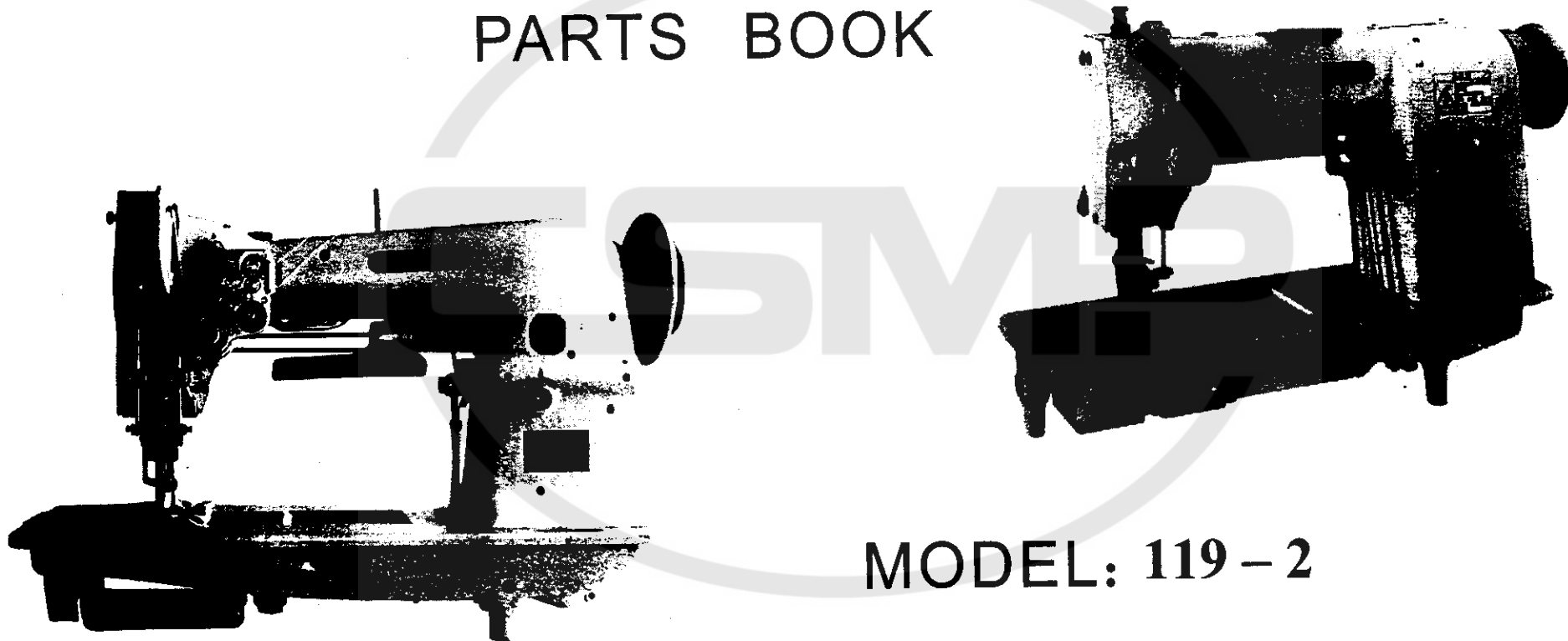

MODEL: 119 - 2



# MODEL: 119 – 2

	INDEX	PAGE
A、	- ARM BED AND IT' S ACCESSORIES -----	2-3
B、	- UPPER THREAD TENSION REGULATOR MECHANISM -----	4-5
C、	- UPPER SHAFT MECHANISM -----	6-7
D、	- NEEDLE BAR AND TAKE-UP LEVER MECHANISM -----	8-11
E、	- NEEDLE ROCKING MECHANISM -----	12-15
F、	- MAIN NEEDLE & CAM MECHANISM -----	16-19
G、	- PRESSER FOOT MECHANISM -----	20-23
H、	- FEED MECHANISM -----	24-27
I、	- LOWER SHAFT AND ROTARY HOOK MECHANISM -----	28-31
J、	- ACCESSORIES -----	32-33
K、	- NUMERICAL PARTS – LIST -----	34-37

# ARM BED AND IT'S ACCESSORIES

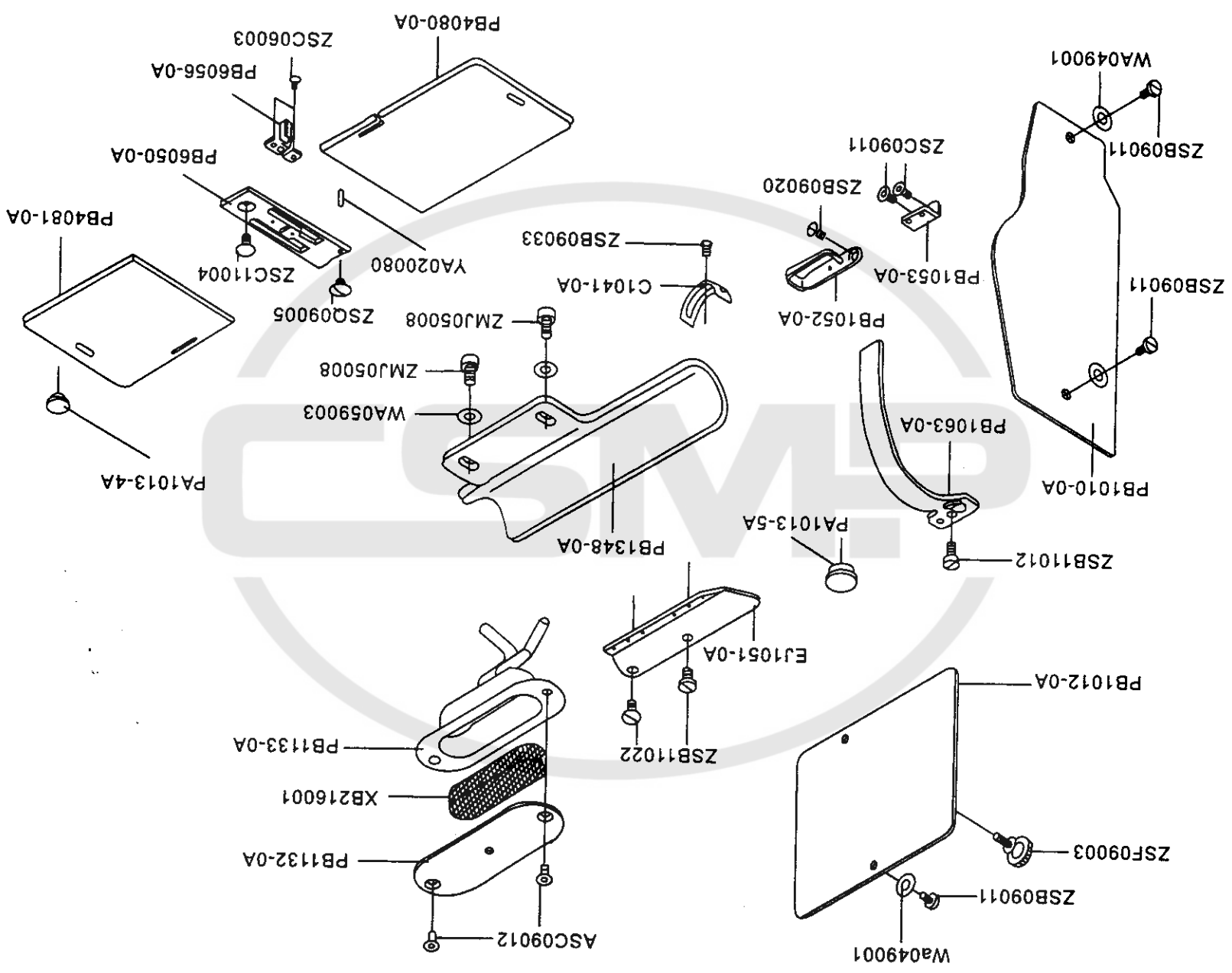

A,

A、

## ARM BED AND IT'S ACCESSORIES

Part No	Name Of Part	Q, TY	Remarks
C1041-0A	----- Stopper -----	1	
EJ1051-0A	----- Top cover thread guide -----	1	
PA1013-4A	----- Oil cap -----	1	
PA1013-5A	----- Oil cap -----	1	
PB1010-0A	----- Face plate -----	1	
PB1012-0A	----- Protecting cover -----	1	
PB1052-0A	----- Thread guide wire -----	1	
PB1053-0A	----- Thread guide wire -----	1	
PB1063-0A	----- Thread take-up cover -----	1	
PB1132-0A	----- Cover Plate-----	1	
PB1133-0A	----- Oil tank -----	1	
PB1348-0A	----- Protecting cover -----	1	
PB4080-0A	----- Slide plate(left) -----	1	
PB4081-0A	----- Slide plate(right) -----	1	
PB6050-0A	----- Needle plate -----	1	
PB6056-0A	----- Protecting needle slide -----	1	
WA049001	----- Washer -----	3	
WA059003	----- Washer -----	2	
XB216001	----- Felt -----	1	
YA020080	----- Pin -----	1	
ZMJ05008	----- Screw(M5×0.8×10) -----	2	
ZSB09011	----- Screw(9/64-40×6.5) -----	3	
ZSB09020	----- Screw(9/64-40×6) -----	1	
ZSB09033	----- Screw(9/64-40×4) -----	1	
ZSB11012	----- Screw(11/64-40×8) -----	1	
ZSB11022	----- Screw(11/64-40×7) -----	2	
ZSC06003	----- Screw(3/32-56×3) -----	2	
ZSC09011	----- Screw(9/64-40×4.5) -----	2	
ZSC09012	----- Screw(9/64-40×7) -----	2	
ZSC11004	----- Screw(11/64-40×8) -----	1	
ZSF09003	----- Screw(9/64-40×8) -----	1	
ZSQ09005	----- Screw(9/64-40×4) -----	1	

B、 UPPER THREAD TENSION REGULATOR MECHANISM

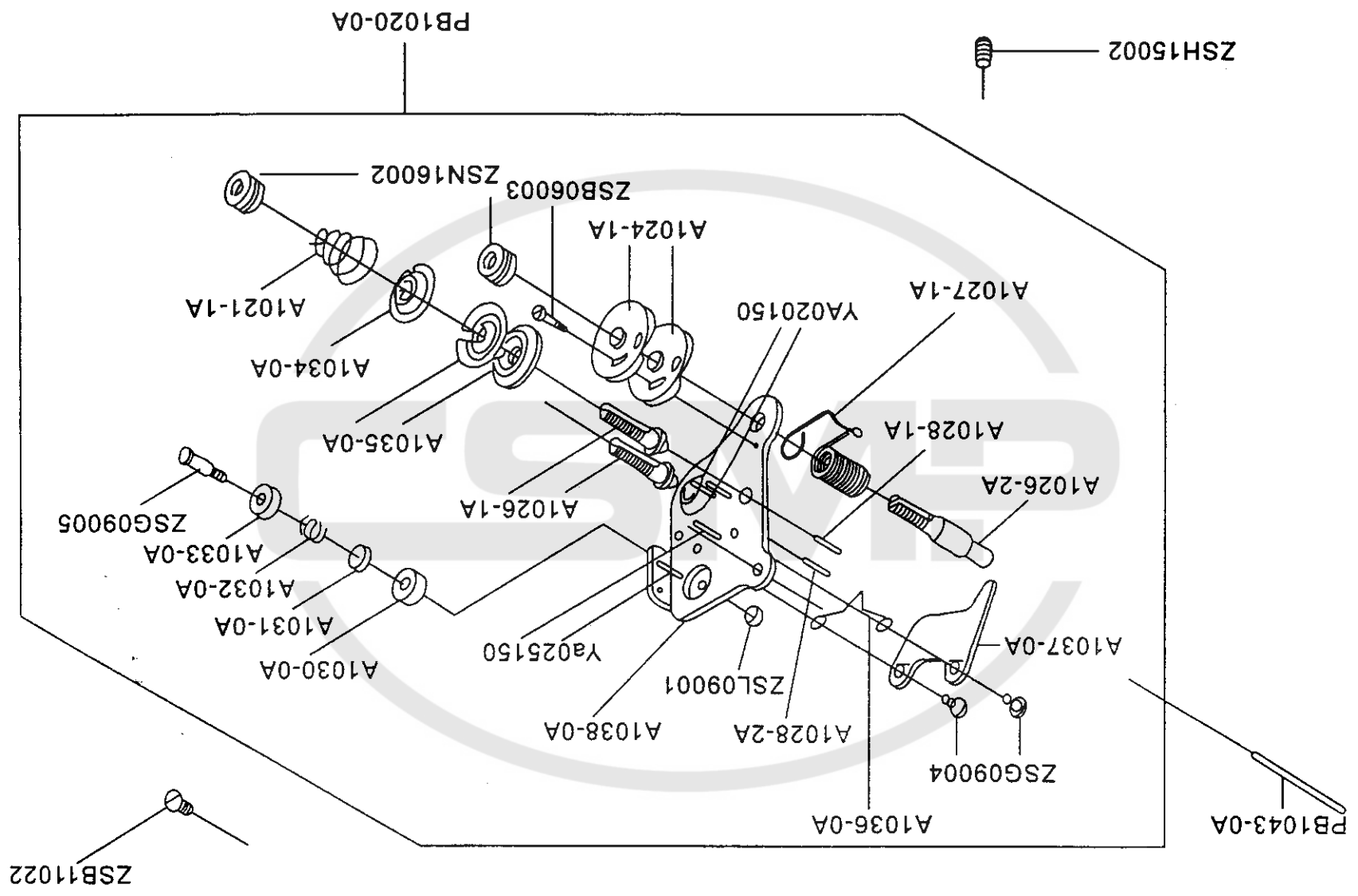

B、

## UPPER THREAD TENSION REGULATOR MECHANISM

Part No	Name Of Part	Q, TY	Remarks
A1021-1A	----- Thread tension spring -----	2	
A1024-1A	----- Tension regulator bracket -----	2	
A1026-1A	----- Thread tension stud -----	2	
A1026-2A	----- Thread tension stud -----	1	
A1027-1A	----- Thread take-up spring -----	1	
A1028-1A	----- Tension release pin -----	1	
A1028-2A	----- Tension release pin -----	1	
A1030-0A	----- Thread guide disk -----	1	
A1031-0A	----- Thread guide disk -----	1	
A1032-0A	----- Spring -----	1	
A1033-0A	----- Thread guide bracket -----	1	
A1034-0A	----- Tension regulator presser disc -----	2	
A1035-0A	----- Tension disc -----	4	
A1036-0A	----- Tension regulator spring -----	1	
A1037-0A	----- Tension release plate -----	1	
A1038-0A	----- Upper thread tension plate -----	1	
PB1020-0A	----- Thread tension regulator assy -----	1	
PB1043-0A	----- Tension release pin -----	1	
YA020150	----- Pin -----	2	
YA025150	----- Pin -----	2	
ZSB06003	----- Screw(3/32-56×12) -----	1	
ZSB11022	----- Screw(11/64-40×7) -----	1	
ZSG09004	----- Screw(9/64-40×2.5) -----	2	
ZSG09005	----- Screw(9/64-40×7) -----	1	
ZSH15002	----- Screw(15/64-28×8) -----	1	
ZSL09001	----- Nut(9/64-40×3) -----	1	
ZSN16002	----- Nut(1/4-40×12) -----	3	

# UPPER SHAFT MECHANISM

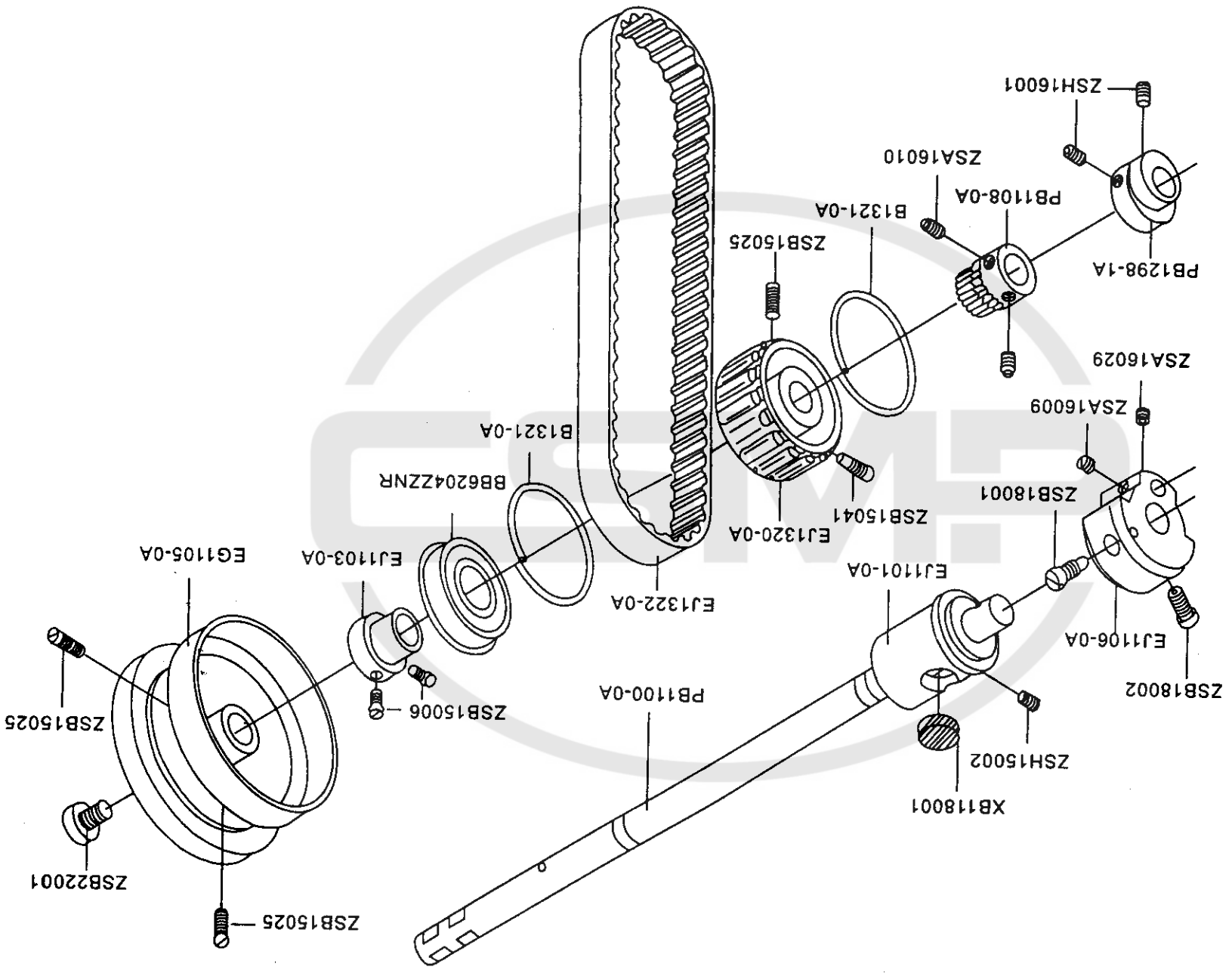



C,

## UPPER SHAFT MECHANISM

Part No	Name Of Part	Q, TY	Remarks
B1321-0A	----- Spring flange -----	2	
BB6204ZZNR	----- Ball bearing -----	1	
EG1105-0A	----- Pulley -----	1	
EJ1101-0A	----- Upper shaft bushing -----	1	
EJ1103-0A	----- Upper shaft bushing -----	1	
EJ1106-0A	----- Crank cam -----	1	
EJ1320-0A	----- Belt sprocket -----	1	
EJ1322-0A	----- Timing belt -----	1	
PB1100-0A	----- Uppeer shaft -----	1	
PB1108-0A	----- Gear -----	1	
PB1298-1A	----- Eccentric -----	1	
XB118001	----- Felt -----	1	
ZSA16009	----- Screw(1/4-40×7) -----	1	
ZSA16010	----- Screw(1/4-40×4.5) -----	2	
ZSA16029	----- Screw(1/4-40×3.5) -----	1	
ZSB15006	----- Screw(15/64-28×8.5) -----	2	
ZSB15025	----- Screw(15/64-28×12) -----	3	
ZSB15041	----- Screw(15/64-28×9) -----	1	
ZSB18001	----- Screw(9/32-28×16) -----	1	
ZSB18002	----- Screw(9/32-28×13) -----	1	
ZSB22001	----- Screw(11/32-28×13) -----	1	
ZSH15002	----- Screw(15/64-28×8) -----	1	
ZSH16001	----- Screw(1/4-40×6) -----	2	

# NEEDLE BAR AND TAKE-UP LEVER MECHANISM

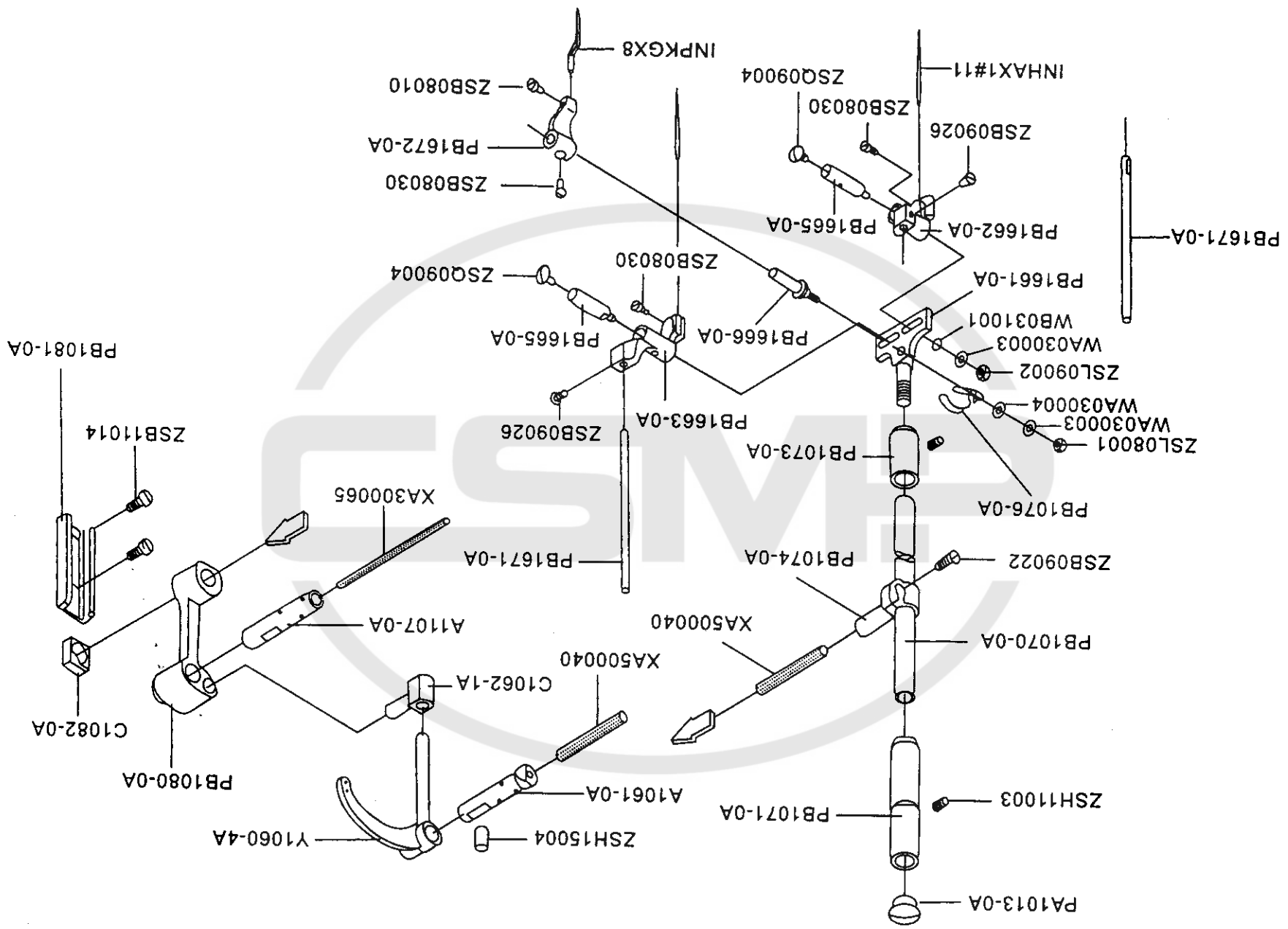

D、

## NEEDLE BAR AND TAKE-UP LEVER MECHANISM

Part No	Name Of Part	Q, TY	Remarks
A1061-0A	----- Take-up lever support stud -----	1	
A1107-0A	----- Needle bar crank pin -----	1	
C1062-1A	----- Needle bar connecting link -----	1	
C1082-0A	----- Needle bar guide slide dlock -----	1	
INHAX1#11	----- Needle -----	2	
INPKGX8	----- Guide needle(pierccr) -----	1	
PA1013-0A	----- Needle bar upper bushing cap -----	1	
PB1070-0A	----- Needle bar -----	1	
PB1071-0A	----- Needle bar bushing(upper) -----	1	
PB1073-0A	----- Needle bar bushing(lower) -----	1	
PB1074-0A	----- Needle bar connecting stud -----	1	
PB1076-0A	----- Needle bar thread guide -----	1	
PB1080-0A	----- Needle bar connecting crank rod -----	1	
PB1081-0A	----- Needle bar connecting link plate -----	1	
PB1661-0A	----- Needle al locate block -----	1	
PB1662-0A	----- Needle clamp(left) -----	.1	
PB1663-0A	----- Needle clamp(right) -----	1	
PB1665-0A	----- Needle clamp shaft -----	2	
PB1666-0A	----- Guide needle supporting shaft -----	1	
PB1671-0A	----- Vertical guide shaft -----	2	
PB1672-0A	----- Guide needle clamp -----	1	
Y1060-4A	----- Thread take-up -----	1	

# NEEDLE BAR AND TAKE-UP LEVER MECHANISM

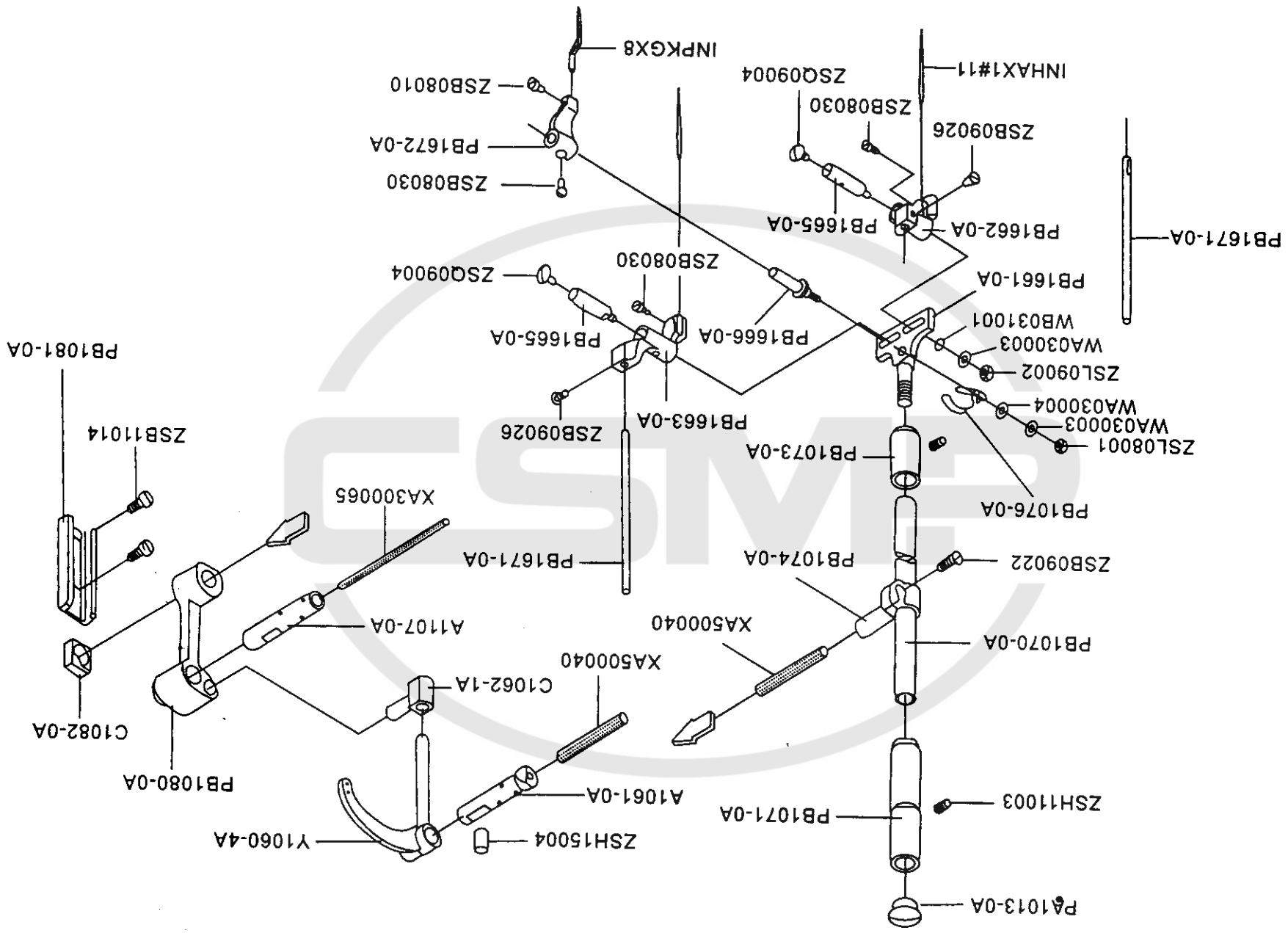

D,

D、

## NEEDLE BAR AND TAKE-UP LEVER MECHANISM

Part No	Name Of Part	Q, TY	Remarks
WA030003	----- Washer -----	3	
WA030004	----- Washer -----	1	
WB031001	----- Spring washer -----	2	
XA300065	----- Oil wick -----	1	
XA500040	----- Oil wick -----	2	
ZSB08010	----- Screw(1/8-44×4.6) -----	1	
ZSB08030	----- Screw(1/8-44×5.6) -----	3	
ZSB09022	----- Screw(9/64-40×8) -----	1	
ZSB09026	----- Screw(9/64-40×5) -----	2	
ZSB11014	----- Screw(11/64-40×8.5) -----	2	
ZSH11003	----- Screw(11/64-40×8.5) -----	2	
ZSH15004	----- Screw(15/64-28×20) -----	1	
ZSL08001	----- Nut(1/8-44×2) -----	1	
ZSL09002	----- Nut(9/64-40×2.5) -----	2	
ZSQ09004	----- Screw(9/64-40×6) -----	2	

# NEEDLE ROCKING MECHANISM (1/2)

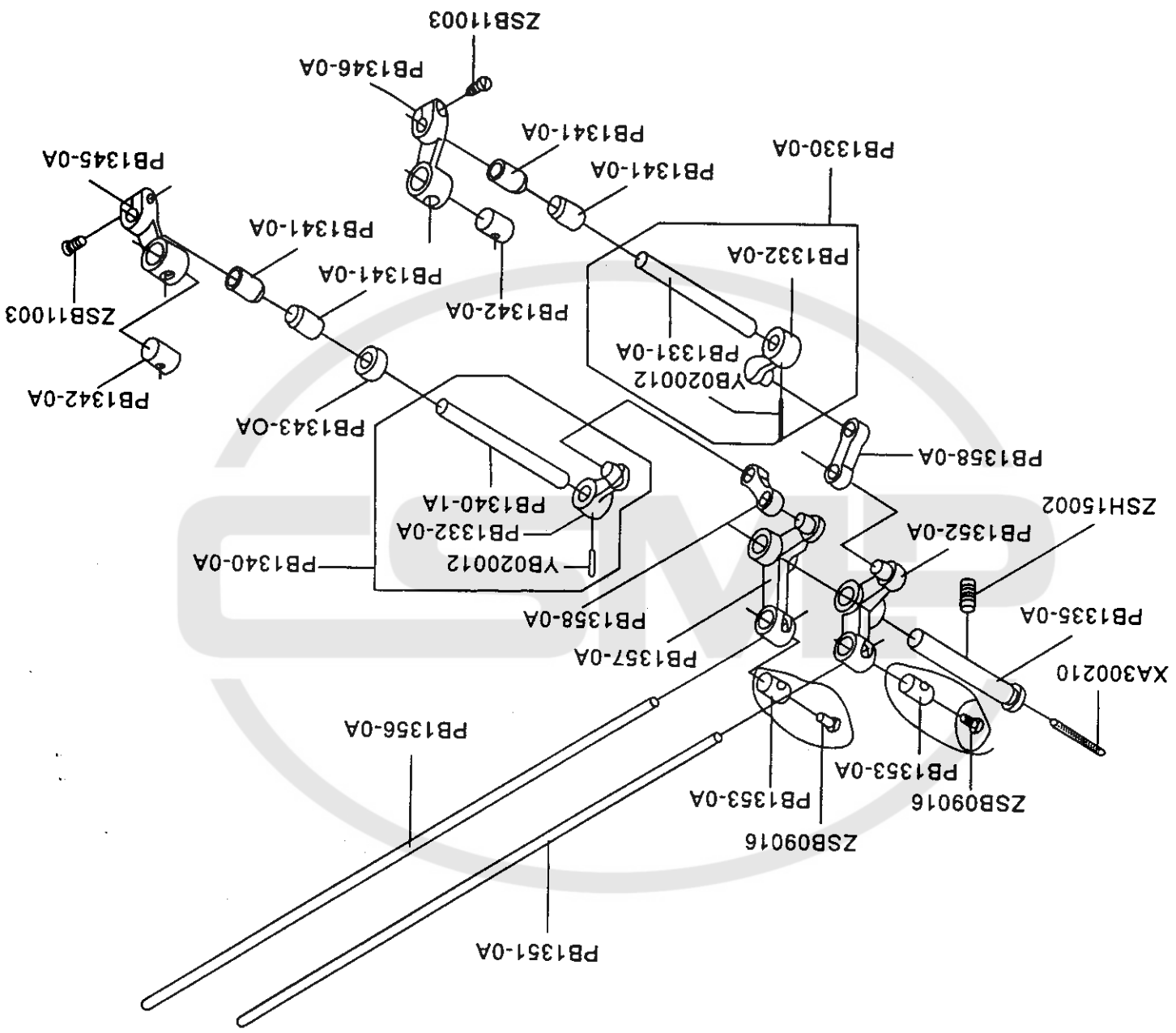

E、

## NEEDLE ROCKING MECHANISM (1/2)

Part No	Name Of Part	Q, TY	Remarks
PB1330-0A	----- Needle vibrating arm set(left) -----	1	
PB1331-0A	----- Needle vibrating shaft -----	1	
PB1332-0A	----- Needle vibrating arm -----	2	
PB1335-0A	----- Bell crank shaft -----	1	
PB1340-0A	----- Needle vibrating arm set (right) -----	1	
PB1340-1A	----- Needle vibrating shaft -----	1	
PB1341-0A	----- Needle vibrating shaft hushing -----	4	
PB1342-0A	----- Vibrating bushing -----	2	
PB1343-0A	----- Spaccr -----	1	
PB1345-0A	----- Needle vimrating arm (fornt right) -----	1	
PB1346-0A	----- Needle vibrating arm (front left) -----	1	
PB1351-0A	----- Flank rod(short) -----	1	
PB1352-0A	----- Bell crank (small) -----	1	
PB1353-0A	----- Flank rod bushing -----	2	
PB1356-0A	----- Flank rod (long) -----	1	
PB1357-0A	----- Bell crank (large) -----	1	
PB1358-0A	----- Vibrating conncting link -----	2	
XA300210	----- Oil wick -----	1	
YB020012	----- Taper pin -----	2	
ZSB09016	----- Screw(9/64-40×6) -----	2	
ZSB11003	----- Screw(11/64-40×9) -----	2	
ZSH15002	----- Screw(15/64-28×8) -----	1	

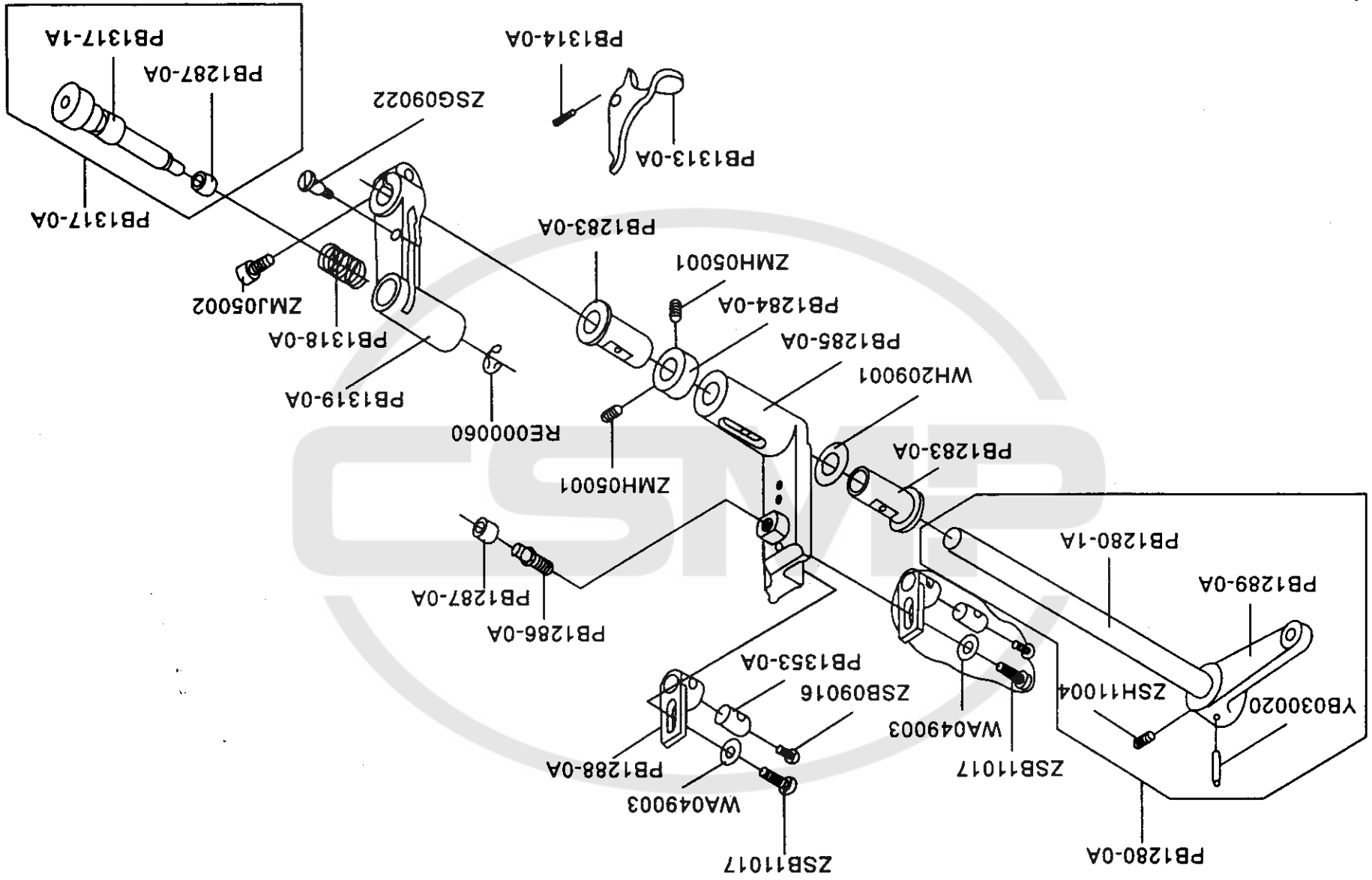

NEEDLE ROCKING MECHANISM (2/2)



E、

## NEEDLE ROCKING MECHANISM (2/2)

Part No	Name Of Part	Q, TY	Remarks
PB1280-0A	----- Presser moving arm set -----	1	
PB1280-1A	----- Presser moving shaft -----	1	
PB1283-0A	----- Needle vibrating lever shaft bushing -----	2	
PB1284-0A	----- Collar -----	1	
PB1285-0A	----- Needle vibrating lever -----	1	
PB1286-0A	----- Needle vibrating lever roller shaft -----	1	
PB1287-0A	----- Roller -----	2	
PB1288-0A	----- Slider -----	2	
PB1289-0A	----- Presser movig arm -----	1	
PB1313-0A	----- Presser activating lever -----	1	
PB1314-0A	----- Spring -----	1	
PB1317-0A	----- Lever base roller shaft set -----	1	
PB1317-1A	----- Lever base roller shaft -----	1	
PB1318-0A	----- spring -----	1	
PB1319-0A	----- Presser activating lever base -----	1	
PB1353-0A	----- Flank rod hushing -----	2	
RE000060	----- E-ring -----	1	
WA049003	----- Washer -----	2	
WH209001	----- Washer -----	1	
YB030020	----- Taper pin -----	1	
ZMH05001	----- Screw(M5 × 0.8 × 5) -----	2	
ZMJ05002	----- Screw(M5 × 0.8 × 12) -----	1	
ZSB09016	----- Screw(9/64-40 × 6) -----	2	
ZSB11017	----- Screw(11/64-40 × 12) -----	2	
ZSG09022	----- Screw(9/64-40 × 5) -----	1	
ZSH11004	----- Screw(11/64-40 × 5) -----	1	

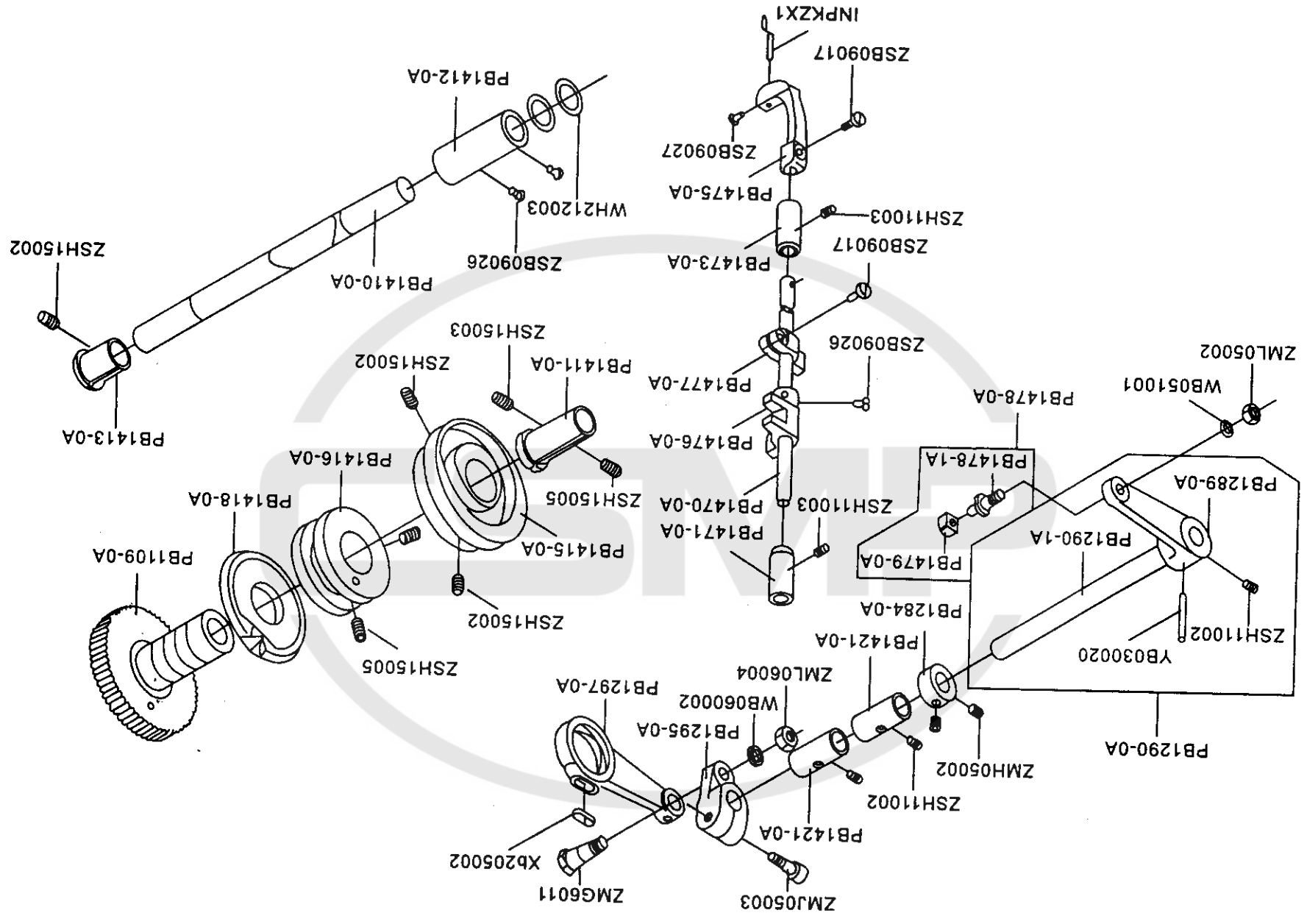

MAIN NEEDLE & CAM MECHANISM

F,

F、

## MAIN NEEDLE &amp; CAM MECHANISM

Part No	Name Of Part	Q, TY	Remarks
INPKZX1	--- Main needle(auxiliary piercer) -----	1	
PB1109-0A	--- Feed lifting rock cam -----	1	
PB1284-0A	--- Collar -----	1	
PB1289-0A	--- Main needle activating arm -----	1	
PB1290-0A	--- Main needle activating arm set -----	1	
PB1290-1A	--- Feed rotating shaft -----	1	
PB1295-0A	--- Main needle vibrating crank -----	1	
PB1297-0A	--- Connection rod -----	1	
PB1410-0A	--- Cam shaft -----	1	
PB1411-0A	--- Bushing(left) -----	1	
PB1412-0A	--- Bushing(middle) -----	1	
PB1413-0A	--- Bushing(right) -----	1	
PB1415-0A	--- Feed rock cam -----	1	
PB1416-0A	--- Needle vibrating groove cam -----	1	
PB1418-0A	--- Presser moving cam -----	1	
PB1421-0A	--- Bushing -----	2	
PB1470-0A	--- Main needle bar -----	1	
PB1471-0A	--- Main needle bar bushing(upper) -----	1	
PB1473-0A	--- Main needle bar bushing(lower) -----	1	
PB1475-0A	--- Main needle clamp -----	1	
PB1476-0A	--- Main needle bar connecting stud -----	1	
PB1477-0A	--- Main needle bar guide -----	1	
PB1478-0A	--- Square block set -----	1	
PB1478-1A	--- Square block shaft -----	1	
PB1479-0A	--- Square block -----	1	



F、

## MAIN NEEDLE &amp; CAM MECHANISM

Name Of Part		Q, TY	Remarks
Part No			
WB051001	----- Spring washer -----	1	
WB060002	----- Spring washer -----	1	
WH212003	----- Washer -----	2	
XB205002	----- Oil felt -----	1	
YB030020	----- Taper pin -----	1	
ZMG06011	----- Screw(M6×1.0×6.5) -----	1	
ZMH05002	----- Screw(M5×0.8×6) -----	2	
ZMJ05003	----- Screw(M5×0.8×15) -----	1	
ZML05002	----- Nut(M5×0.8×4) -----	1	
ZML06004	----- Nut(M6×1.0×4.8) -----	1	
ZSB09017	----- Screw(9/64-40×8) -----	2	
ZSB09026	----- Screw(9/64-40×5) -----	3	
ZSB09027	----- Screw(9/64-40×4) -----	1	
ZSH11002	----- Screw(11/64-40×6) -----	3	
ZSH15002	----- Screw(11/64-40×8.5) -----	2	
ZSH15002	----- Screw(15/64-28×8) -----	3	
ZSH15003	----- Screw(15/64-28×5) -----	1	
ZSH15005	----- Screw(15/64-28×4) -----	3	

# PRESSER FOOT BAT MECHANISM

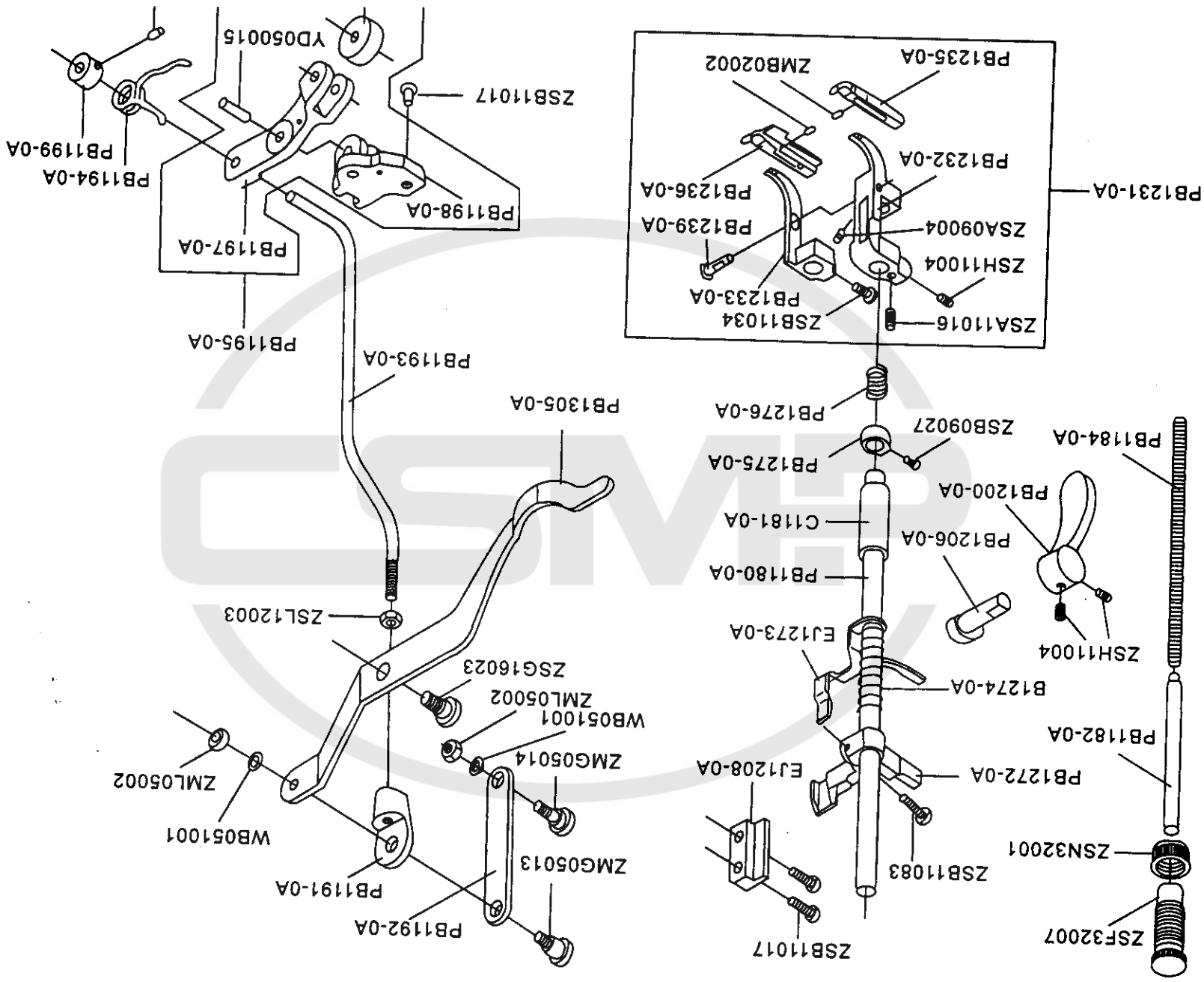

G、

## PRESSER FOOT MECHANISM

Part No	Name Of Part	Q, TY	Remarks
B1274-0A	----- Spring -----	1	
C1181-0A	----- Presser bar bushing -----	1	
EJ1208-0A	----- Position plate -----	1	
EJ1273-0A	----- Tension release slide -----	1	
PB1180-0A	----- Presser bar -----	1	
PB1182-0A	----- Spring guide bar complete -----	1	
PB1184-0A	----- Spring -----	1	
PB1191-0A	----- Knee lifter lever joint -----	1	
PB1192-0A	----- Knee lifter lever plate -----	1	
PB1193-0A	----- Knee lifter connecting rod -----	1	
PB1194-0A	----- Spring -----	1	
PB1195-0A	----- Knee lifter connecting rod finger -----	1	
PB1196-0A	----- Trundle -----	1	
PB1197-0A	----- Stitch tongue supporter -----	1	
PB1198-0A	----- Stitch tongue supporter -----	1	
PB1199-0A	----- Collar -----	1	
PB1200-0A	----- Presser bar lifter -----	1	
PB1206-0A	----- Presser bar lifter shaft -----	1	
PB1231-0A	----- Presser foot set -----	1	
PB1232-0A	----- Presser foot shank(left) -----	1	
PB1233-0A	----- Presser foot shank(right) -----	1	
PB1235-0A	----- Presser foot(left) -----	1	
PB1236-0A	----- Presser foot(right) -----	1	
PB1239-0A	----- Pin -----	1	
PB1272-0A	----- Presser bar lifter -----	1	
PB1275-0A	----- Presser bar bracket -----	1	
PB1276-0A	----- Spring -----	1	
PB1305-0A	----- Foot lifter lifting lever -----	1	

# PRESSER FOOT BAT MECHANISM

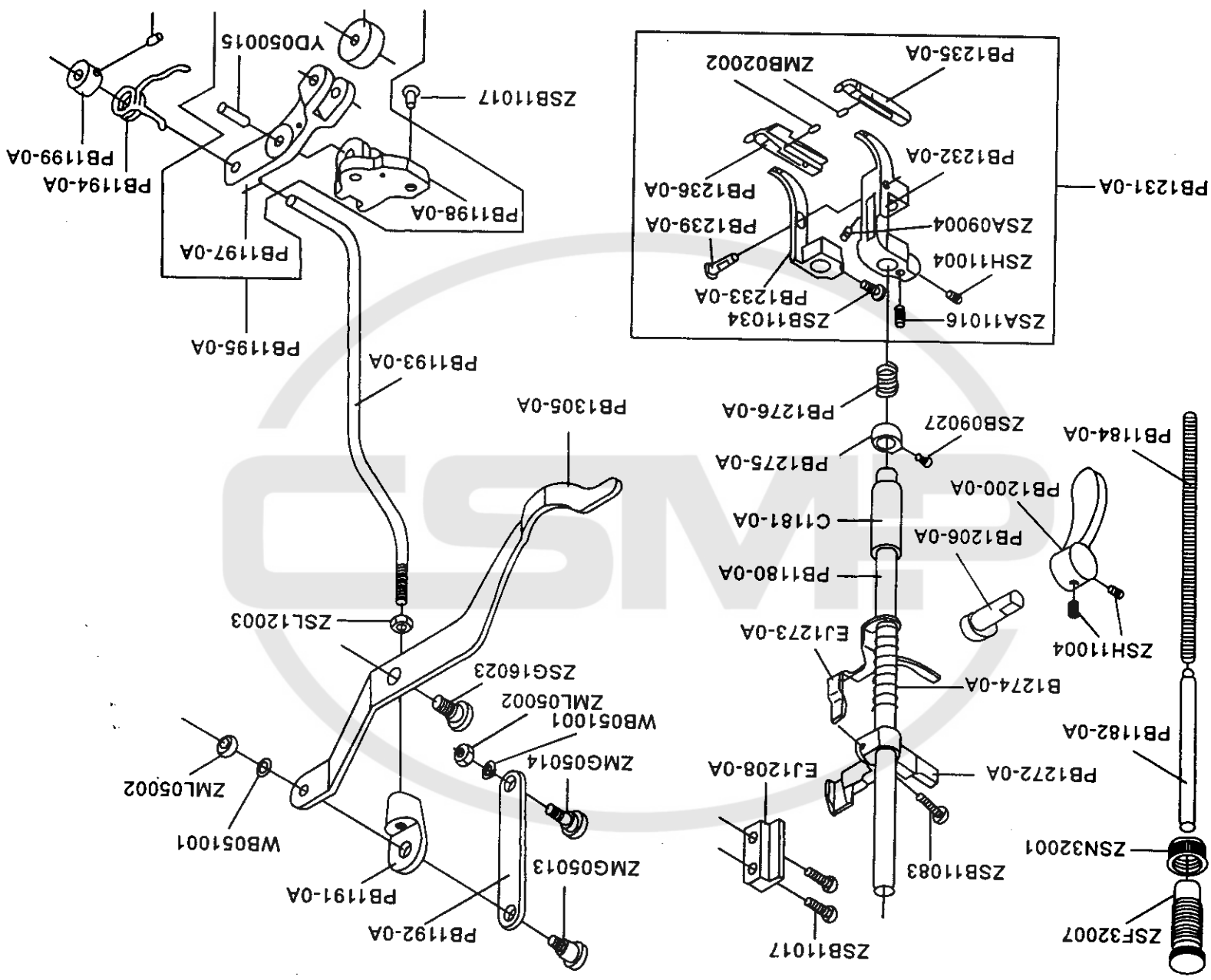



G、

## PRESSER FOOT MECHANISM

Part No	Name Of Part	Q, TY	Remarks
WB051001	Spring washer	2	
YD050015	Spring pin	1	
ZMB02002	Screw(M2 × 0.4 × 2)	2	
ZMG05013	Screw(M5 × 0.8 × 8)	1	
ZMG05014	Screw(M5 × 0.8 × 7)	1	
ZML05002	Nut(M5 × 0.8 × 4)	2	
ZSA09004	Screw(9/64-40 × 2.8)	1	
ZSA11016	Screw(11/64-40 × 10)	1	
ZSB09027	Screw(9/64-40 × 4)	1	
ZSB11017	Screw(11/64-40 × 12)	4	
ZSB11034	Screw(11/64-40 × 8)	1	
ZSB11083	Screw(11/64-40 × 18)	1	
ZSF32007	Screw(1/2-28 × 36)	1	
ZSG16023	Screw(1/4-24 × 8)	1	
ZSH11004	Screw(11/64-40 × 5)	4	
ZSL12003	Nut(3/16-32 × 3)	1	
ZSN32001	Nut(1/2-28 × 8)	1	

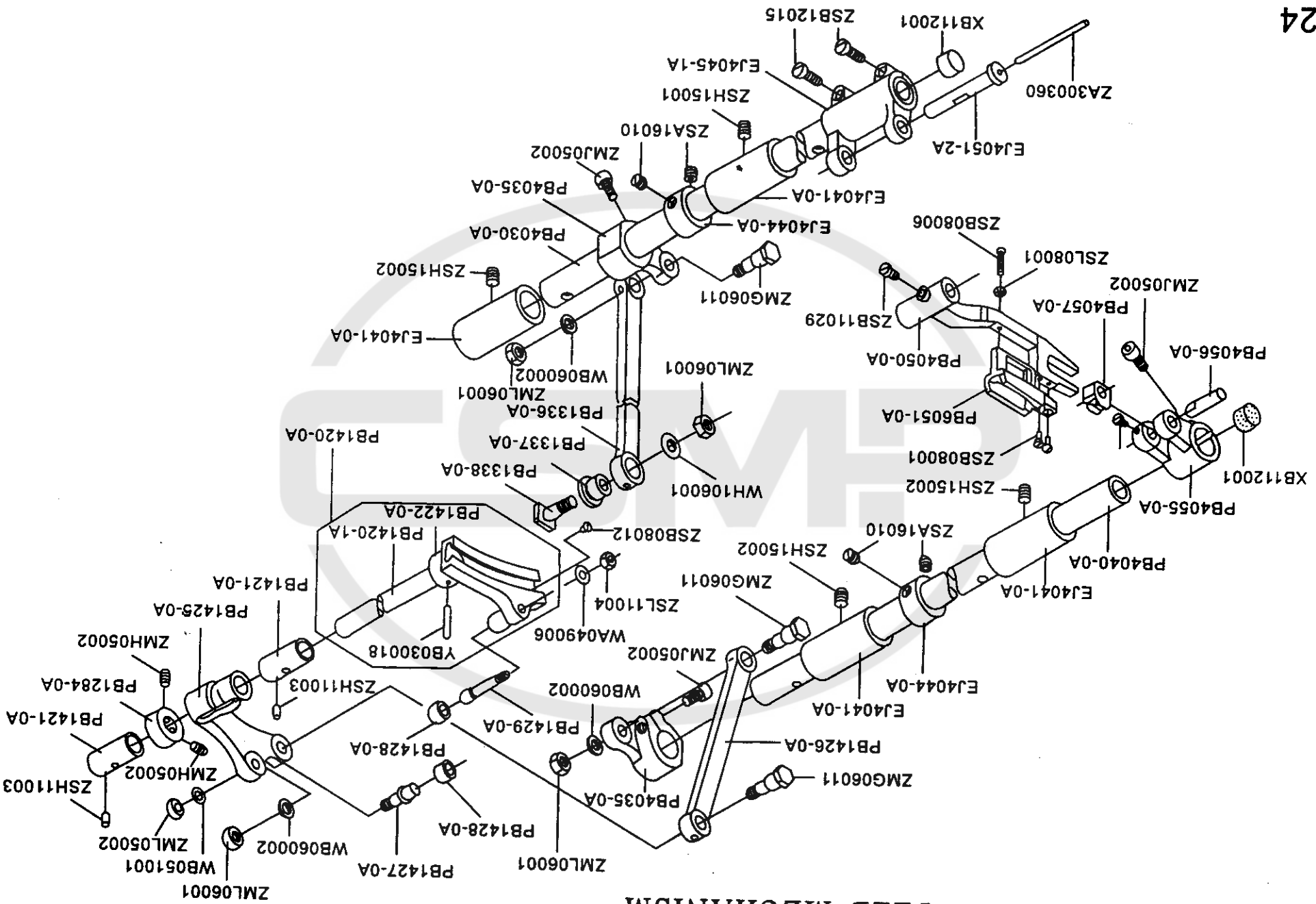

FEED MECHANISM

H、

## FEED MECHANISM

		Name Of Part			
Part No				Q, TY	Remarks
EJ4041-0A	-----	Feed rock shaft bushing	-----	4	
EJ4044-0A	-----	Collar	-----	2	
EJ4045-1A	-----	Feed rock shaft crank	-----	1	
EJ4051-2A	-----	Feed bar shaft	-----	1	
PB1284-0A	-----	Collar	-----	1	
PB1336-0A	-----	Feed rock crank rod	-----	1	
PB1337-0A	-----	Bushing	-----	1	
PB1338-0A	-----	Feed rock crank rod pin	-----	1	
PB1420-0A	-----	Feed rock drive grooved link set	-----	1	
PB1420-1A	-----	Feed rock shaft	-----	1	
PB1421-0A	-----	Feed rock shaft bushing	-----	2	
PB1422-0A	-----	Feed rock drive grooved	-----	1	
PB1425-0A	-----	Feed lifting rock vibrating arm	-----	1	
PB1426-0A	-----	Feed lifting rock crank rod	-----	1	
PB1427-0A	-----	Roller shaft	-----	1	
PB1428-0A	-----	Roller	-----	2	
PB1429-0A	-----	Roller shaft	-----	1	
PB4030-0A	-----	Feed rock shaft	-----	1	
PB4035-0A	-----	Feed lifting rock shaft crank	-----	2	
PB4040-0A	-----	Feed rock shaft	-----	1	
PB4050-0A	-----	Feed bar	-----	1	
PB4055-0A	-----	Feed lifting rock shaft crank	-----	2	
PB4056-0A	-----	Roller shaft	-----	1	
PB4057-0A	-----	Square block	-----	1	
PB6051-0A	-----	Feed cog	-----	1	



H、

## FEED MECHANISM

## Name Of Part

Part No	Name Of Part	Q, TY	Remarks
WA049006	----- Washer -----	1	
WB051001	----- Spring washer -----	1	
WB060002	----- Spring washer -----	3	
WH106001	----- Washer -----	1	
XA300360	----- Oil wick -----	1	
XB112001	----- Oil felt -----	2	
YB030018	----- Taper pin -----	1	
ZMG06011	----- Screw(M6 × 1.0 × 6.5) -----	3	
ZMH05002	----- Screw(M5 × 0.8 × 6) -----	2	
ZMJ05002	----- Screw(M5 × 0.8 × 12) -----	3	
ZML05002	----- Nut(M5 × 0.8 × 4) -----	1	
ZML06001	----- Nut(M6 × 1.0 × 4.8) -----	4	
ZSA16010	----- Screw(1/4-40 × 4.5) -----	4	
ZSB08001	----- Screw(1/8-44 × 6) -----	2	
ZSB08006	----- Screw(1/8-44 × 12) -----	1	
ZSB08012	----- Screw(1/8-44 × 3.5) -----	1	
ZSB09026	----- Screw(9/64-40 × 5) -----	1	
ZSB11029	----- Screw(11/64-40 × 7) -----	1	
ZSB12015	----- Screw(3/16-28 × 12) -----	2	
ZSH11003	----- Screw(11/64-40 × 8.5) -----	2	
ZSH15001	----- Screw(15/64-28 × 6) -----	1	
ZSH15002	----- Screw(15/64-28 × 8) -----	3	
ZSL08001	----- Nut(1/8-44 × 2) -----	1	
ZSL11004	----- Nut(11/64-40 × 3) -----	1	

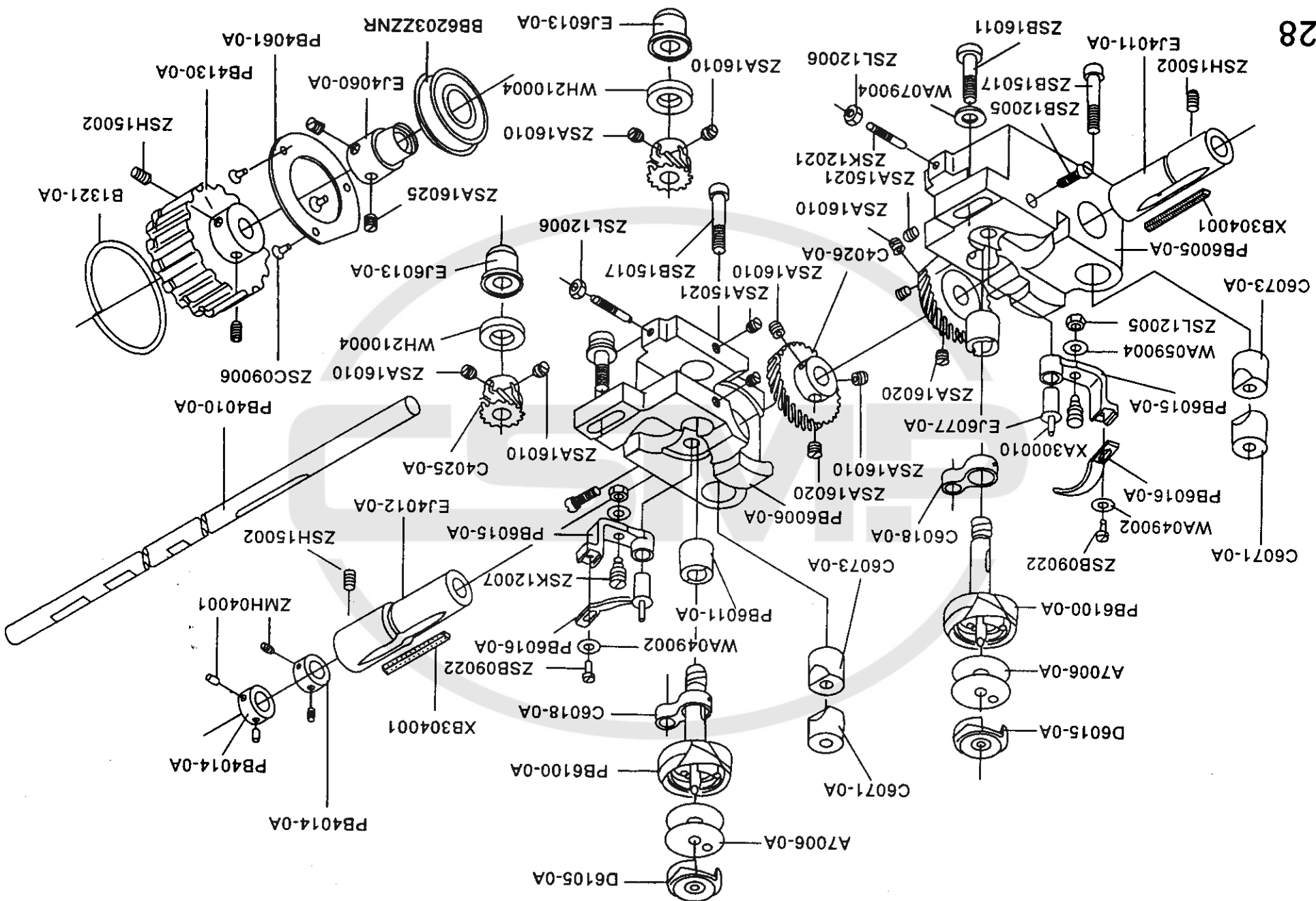

LOWER SHAFT AND ROTARY HOOK MECHANISM

I,

## LOWER SHAFT AND ROTARY HOOK MECHANISM

Name Of Part		Q, TY	Remarks
Part No			
A7006-0A	---- Bobbin -----	2	
B1321-0A	---- Side ring -----	1	
BB6203ZZNR	---- Ball bearing -----	1	
C4025-0A	---- Pinion -----	2	
C4026-0A	---- Spiral gear -----	2	
C6018-0A	---- Opener link -----	2	
C6071-0A	---- Pinch sleeve (upper) -----	2	
C6073-0A	---- Pinch sleeve (lower) -----	2	
D6105-0A	---- Bobbin case complete -----	2	
EJ4011-0A	---- Lower shaft bushing(left) -----	1	
EJ4012-0A	---- Lower shaft bushing(right) -----	1	
EJ4060-0A	---- Bearing holder -----	1	
EJ6013-0A	---- Rotary hook shaft hushing (lower) -----	2	
EJ6077-0A	---- Opener crank stud -----	2	
PB4010-0A	---- Lower shaft -----	1	
PB4014-0A	---- Collar -----	2	
PB4061-0A	---- Bearing presser -----	1	
PB4130-0A	---- Timing belt wheel -----	1	
PB6005-0A	---- Rotary hook base(left) -----	1	
PB6006-0A	---- Rotary hook base(right) -----	1	
PB6011-0A	---- Rotary hook shaft bushing(upper) -----	2	
PB6015-0A	---- Opener crank -----	2	
PB6016-0A	---- Bobbin case opener -----	2	
PB6100-0A	---- Rotary hook assembly -----	2	

LOWER SHAFT AND ROTARY HOOK MECHANISM

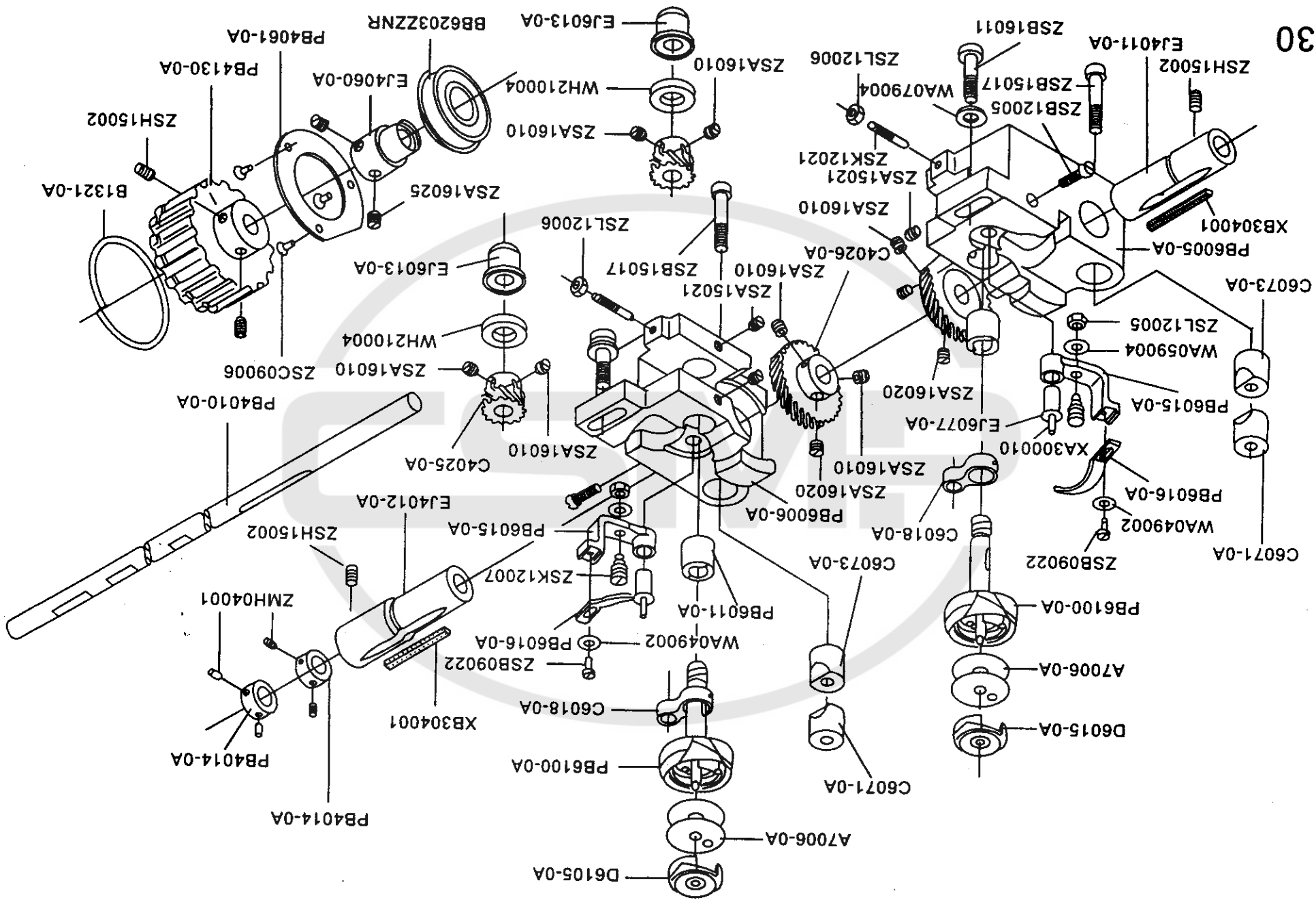



I,

## LOWER SHAFT AND ROTARY HOOK MECHANISM

Part No	Name Of Part	Q, TY	Remarks
WA049002	Washer	2	
WA059004	Washer	2	
WA079004	Washer	2	
WH210004	Washer	2	
XA300010	Oil wick	2	
XB304001	Oil felt	2	
ZMH04001	Screw(M4 × 0.7 × 4)	4	
ZSA15021	Screw(15/64-28 × 4.5)	4	
ZSA16010	Screw(1/4-40 × 4.5)	8	
ZSA16020	Screw(1/4-40 × 5.5)	2	
ZSA16025	Screw(1/4-40 × 6)	2	
ZSB09022	Screw(9/64-40 × 8)	2	
ZSB12005	Screw(3/16-28 × 15)	2	
ZSB15017	Screw(15/64-28 × 31.4)	2	
ZSB16011	Screw(1/4-24 × 25)	2	
ZSC09006	Screw(9/64-40 × 8)	3	
ZSH15002	Screw(15-64-28 × 8)	4	
ZSK12007	Screw	2	
ZSK12021	Screw	2	
ZSL12005	Nut(3/16-32 × 3.5)	2	
ZSL12006	Nut(3/16-32 × 3)	2	

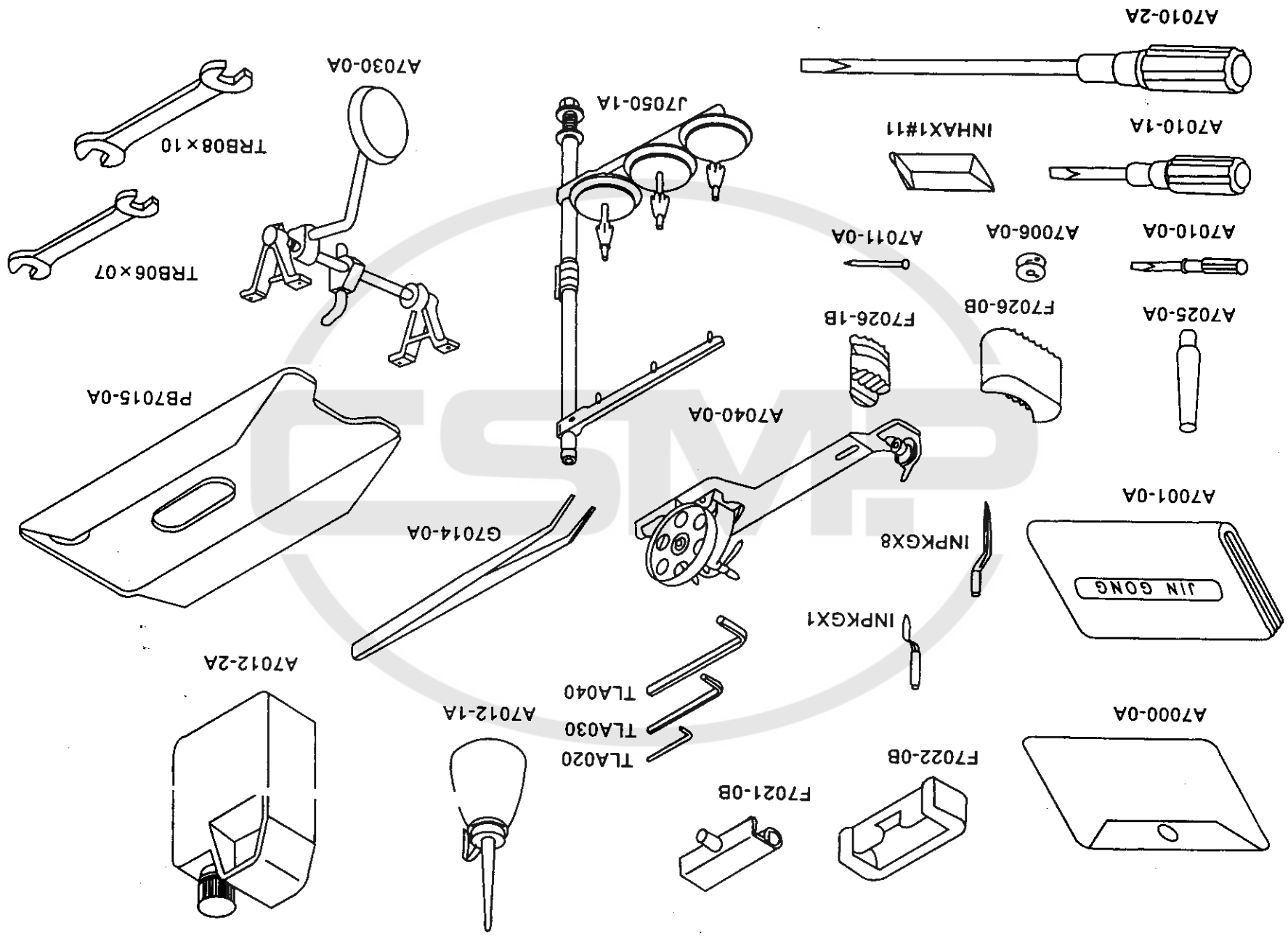

ACCESSORIES

J、

## ACCESSORIES

Part No	Name Of Part	Q, TY	Remarks
A7000-0A	----- Accessory bag -----	1	
A7001-0A	----- Vinyl cover -----	1	
A7006-0A	----- Bobbin -----	4	
A7010-0A	----- Screw driver(small) -----	1	
A7010-1A	----- Screw driver (middle) -----	1	
A7010-2A	----- Screw driver (large) -----	10	
A7011-0A	----- Nail -----	1	
A7012-1A	----- Oiler -----	1	
A7012-2A	----- Oiler -----	1	
A7025-0A	----- Head rest wood -----	1	
A7030-0A	----- Knee lifter assy -----	1	
A7040-0A	----- Bobbin winder -----	1	
F7021-0B	----- Head hinge -----	2	
F7022-0B	----- Rubber hinge -----	2	
F7026-0B	----- Head cushion -----	2	
F7026-1B	----- Head cushion -----	2	
G7014-0A	----- Tweezers -----	1	
INHAX1#11	----- Needle -----	10	
INPKGX8	----- Guide needle (piercer) -----	1	
INPKZX1	----- Main needle (auxiliary picrcer) -----	1	
J7050-1A	----- Thread stand -----	1	
PB7015-0A	----- Oil pan -----	1	
TLA020	----- Wrench 2mm -----	1	
TLA030	----- Wrench 3mm -----	1	
TLA040	----- Wrench 4mm -----	1	
TRB06×07	----- Spanner 6×7 -----	1	
TRB08×10	----- Spanner 8×10 -----	1	

PART NO		PAGE		PART NO		PAGE		PART NO		PAGE	
A1021-1A	4	A7030-0A	32	EJ4044-0A	24	PB1074-0A	8	A1024-1A	4	A7040-0A	4
A1026-1A	4	B1274-0A	20	EJ4051-2A	24	PB1076-0A	8	A1026-2A	4	B1321-0A	4
A1027-1A	4	BB6203ZZNR	28	EJ4060-0A	28	PB1080-0A	8	A1027-1A	4	BB6204ZZNR	4
A1028-1A	4	BB6204ZZNR	6	EJ6013-0A	28	PB1100-0A	6	A1028-1A	4	C1041-0A	4
A1028-2A	4	C1041-0A	2	F7021-0B	32	PB1108-0A	6	A1028-2A	4	C1062-1A	4
A1030-0A	4	C1062-1A	8	F7022-0B	32	PB1109-0A	16	A1030-0A	4	C1082-0A	4
A1031-0A	4	C1082-0A	8	F7026-0B	32	PB1133-0A	2	A1031-0A	4	C4025-0A	4
A1032-0A	4	C1181-0A	20	F7026-1B	32	PB1180-0A	20	A1032-0A	4	C4026-0A	4
A1033-0A	4	C4025-0A	28	G7014-0A	32	PB1182-0A	20	A1033-0A	4	C6018-0A	4
A1034-0A	4	C4026-0A	28	INHAX1#11	8,32	PB1184-0A	20	A1034-0A	4	C6071-0A	4
A1035-0A	4	C6018-0A	28	INPKGX8	8,32	PB1191-0A	20	A1035-0A	4	C6073-0A	4
A1036-0A	4	C6071-0A	28	INPKZX1	16,32	PB1192-0A	20	A1036-0A	4	D6105-0A	4
A1037-0A	4	C6073-0A	28	J7050-1A	32	PB1193-0A	20	A1037-0A	4	EG1105-0A	8
A1038-0A	4	D6105-0A	28	PA1013-0A	8	PB1194-0A	20	A1038-0A	4	EJ1051-0A	8
A1061-0A	8	EG1105-0A	6	PA1013-4A	2	PB1195-0A	20	A1061-0A	8	EJ1101-0A	32
A1107-0A	8	EJ1051-0A	2	PA1013-5A	2	PB1196-0A	20	A1107-0A	8	EJ1103-0A	32
A7000-0A	32	EJ1101-0A	6	PB1010-0A	2	PB1197-0A	20	A7000-0A	32	EJ1106-0A	28,32
A7001-0A	32	EJ1103-0A	6	PB1012-0A	2	PB1198-0A	20	A7001-0A	32	EJ1110-0A	6
A7006-0A	28,32	EJ1106-0A	6	PB1020-0A	4	PB1199-0A	20	A7006-0A	28,32	EJ1208-0A	20
A7010-0A	32	EJ1208-0A	20	PB1043-0A	4	PB1200-0A	20	A7010-0A	32	EJ1273-0A	32
A7010-1A	32	EJ1273-0A	20	PB1052-0A	2	PB1206-0A	20	A7010-1A	32	EJ1322-0A	32
A7010-2A	32	EJ1322-0A	6	PB1053-0A	2	PB1231-0A	20	A7010-2A	32	EJ4011-0A	32
A7011-0A	32	EJ4011-0A	28	PB1063-0A	2	PB1232-0A	20	A7011-0A	32	EJ4012-0A	32
A7012-1A	32	EJ4012-0A	28	PB1070-0A	8	PB1233-0A	20	A7012-1A	32	EJ4041-0A	24
A7012-2A	32	EJ4041-0A	24	PB1071-0A	8	PB1235-0A	20	A7012-2A	32		
A7025-0A	32			PB1073-0A	8	PB1236-0A	20	A7025-0A	32		

NUMERICAL PARTS-LIST

K.

## NUMERICAL PARTS-LIST

PART NO	PAGE	PART NO	PAGE	PART NO	PAGE	PART NO	PAGE
PB1239-0A	20	PB1335-0A	12	PB1422-0A	24	PB4055-0A	24
PB1272-0A	20	PB1336-0A	24	PB1425-0A	24	PB4056-0A	24
PB1275-0A	20	PB1337-0A	24	PB1426-0A	24	PB4057-0A	24
PB1276-0A	20	PB1338-0A	24	PB1427-0A	24	PB4061-0A	28
PB1280-0A	14	PB1340-0A	12	PB1428-0A	24	PB4080-0A	2
PB1280-1A	14	PB1340-1A	12	PB1429-0A	24	PB4081-0A	2
PB1283-0A	14	PB1341-0A	12	PB1470-0A	16	PB4130-0A	28
PB1284-0A	14,16,24	PB1342-0A	12	PB1471-0A	16	PB6005-0A	28
PB1285-0A	14	PB1343-0A	12	PB1473-0A	16	PB6006-0A	28
PB1286-0A	14	PB1343-0A	12	PB1475-0A	16	PB6011-0A	28
PB1287-0A	14	PB1345-0A	12	PB1476-0A	16	PB6015-0A	28
PB1288-0A	14	PB1346-0A	12	PB1477-0A	16	PB6016-0A	28
PB1289-0A	14,16	PB1348-0A	2	PB1478-0A	16	PB6050-0A	2
PB1290-0A	16	PB1351-0A	12	PB1478-1A	16	PB6051-0A	24
PB1290-1A	16	PB1352-0A	12	PB1479-0A	16	PB6056-0A	2
PB1295-0A	16	PB1353-0A	12,14	PB1661-0A	8	PB6100-0A	28
PB1297-0A	16	PB1356-0A	12	PB1662-0A	8	PB7015-0A	32
PB1298-0A	6	PB1357-0A	12	PB1663-0A	8	RE000060	14
PB1305-0A	20	PB1358-0A	12	PB1665-0A	8	TLA020	32
PB1313-0A	14	PB1410-0A	16	PB1666-0A	8	TLA030	32
PB1314-0A	14	PB1411-0A	16	PB1671-0A	8	TLA040	32
PB1317-0A	14	PB1412-0A	16	PB1672-0A	8	TRB06×07	32
PB1317-1A	14	PB1413-0A	16	PB4010-0A	28	TRB08×10	32
PB1318-0A	14	PB1415-0A	16	PB4014-0A	28	WA030003	10
PB1319-0A	14	PB1416-0A	16	PB4030-0A	24	WA030004	10
PB1330-0A	12	PB1418-0A	16	PB4035-0A	24	WA049001	2
PB1331-0A	12	PB1420-0A	24	PB4040-0A	24	WA049002	30
PB1332-0A	12	PB1420-1A	24	PB4050-0A	24	WA049003	14
		PB1421-0A	16,24				

PART NO	PAGE	PART NO	PAGE	PART NO	PAGE	PART NO	PAGE
WA049006	26	YD050015	22	ZSB09011	2	ZSC09011	2
WA059003	2	ZMB02002	22	ZSB09016	12,14	ZSC09012	2
WA059004	30	ZMG05013	22	ZSB09017	18	ZSC11004	2
WA079004	30	ZMG05014	22	ZSB09020	2	ZSF09003	2
WB031001	10	ZMG06011	18,26	ZSB09022	10,30	ZSF32007	22
WB051001	18,22,26	ZMH04001	30	ZSB09026	10,18,26	ZSG09004	4
WB060002	18,26	ZMH05001	14	ZSB09027	18,22	ZSG09005	4
WH106001	26	ZMH05002	18,26	ZSB09033	2	ZSG09022	14
WH209001	14	ZMJ05002	14,26	ZSB11003	12	ZSG16023	22
WH210004	30	ZMJ05003	18	ZSB11012	2	ZSH11002	18
WH212003	18	ZMJ05008	2	ZSB11014	10	ZSH11003	10,18,22
XA300010	30	ZML05002	18,22,26	ZSB11017	14,22	ZSH11004	14,22
XA300065	10	ZML06001	26	ZSB11022	2,4	ZSH15001	26
XA300210	12	ZML06004	18	ZSB11029	26	ZSH15002	4,6,12
XA300360	26	ZSA09004	22	ZSB11034	22	ZSH15003	18,26,30
XA500040	10	ZSA11016	22	ZSB11083	22	ZSH15004	10
XB112001	26	ZSA15021	30	ZSB12005	30	ZSH15005	18
XB118001	6	ZSA16009	6	ZSB12015	26	ZSH15006	18
XB205002	18	ZSA16010	6,26,30	ZSB15006	6	ZSH16001	6
XB216001	2	ZSA16020	30	ZSB15017	30	ZSK12007	30
XB304001	30	ZSA16025	30	ZSB15025	6	ZSK12021	30
Y1060-4A	8	ZSA16029	6	ZSB15041	6	ZSL08001	10,26
YA020080	2	ZSB06003	4	ZSB16011	30	ZSL09001	4
YA020150	4	ZSB08001	26	ZSB18001	6	ZSL09002	10
YA025150	4	ZSB08006	26	ZSB18002	6	ZSL11004	26
YB020012	12	ZSB08010	10	ZSB22001	6	ZSL12003	22
YB030018	26	ZSB08012	26	ZSC06003	2	ZSL12005	30
YB030020	14,18	ZSB08030	10	ZSC09006	30	ZSL12006	30

NUMERICAL PARTS-LIST







# **GLOBAL**

## **119-2 SERIES**

**119-2 / N**

**119-2 / W**

**HIGH SPEED TWO NEEDLE PICOT  
STITCH SEWING MACHINE**

# **INSTRUCTION MANUAL**

## INSTRUCTION MANUAL

1. Names of the main parts
2. Directions for use
  - (1) Setting the stitching needles
  - (2) Winding the under thread
  - (3) Threading the bobbin case
  - (4) Placing the bobbin case in the rotary hook
  - (5) Upper threading of the machine
  - (6) Drawing up the under thread
  - (7) Under thread tension
  - (8) Upper thread tension
  - (9) Adjusting the presser foot pressure
  - (10) Adjusting the stitch length
  - (11) Setting the main needle (Auxiliary piercer)
  - (12) Setting the guide needle (Piercer)
  - (13) Sewing a corner and a small circle
  - (14) Sewing a right-angle corner
3. Lubrication
4. Troubles and steps to take
5. Machine head specification

# 1. Names of the main parts

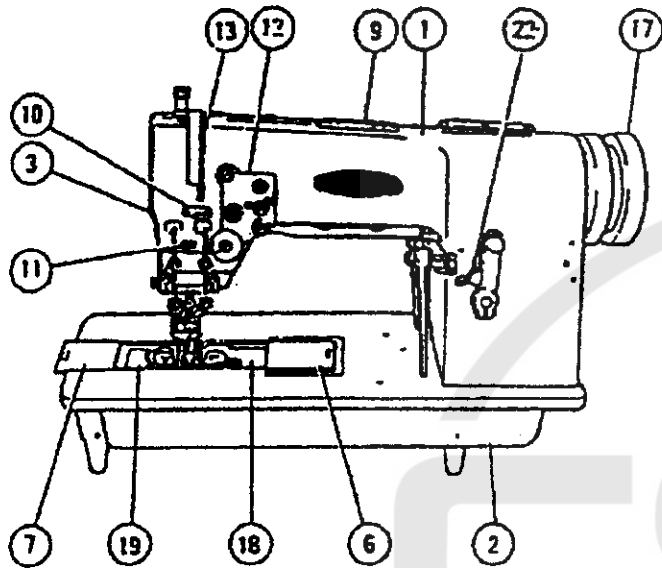

- (1) Arm
- (2) Bed
- (3) Face plate
- (4) Side cover
- (5) Oil tank cover
- (6) Bed slide (Right)
- (7) Bed slide (Left)
- (8) Throat plate
- (9) Thread guide, A
- (10) Thread guide, B
- (11) Thread guide, C
- (12) Thread tension regulator (Assembly)
- (13) Take-up lever
- (14) Guide needle (Piercer)
- (15) Stitching needles
- (16) Main needle (Auxiliary piercer)
- (17) Hand wheel
- (18) Rotary hook base (Right)
- (19) Rotary hook base (Left)
- (20) Rotary hook
- (21) Feeder
- (22) Presser foot actuating lever
- (23) Presser foot lifting arm
- (24) Presser foot (Assembly)
- (25) Pressure regulating screw

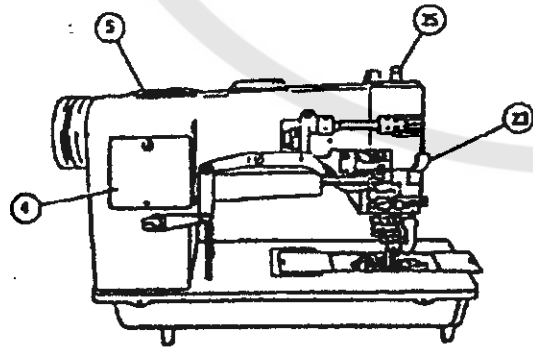
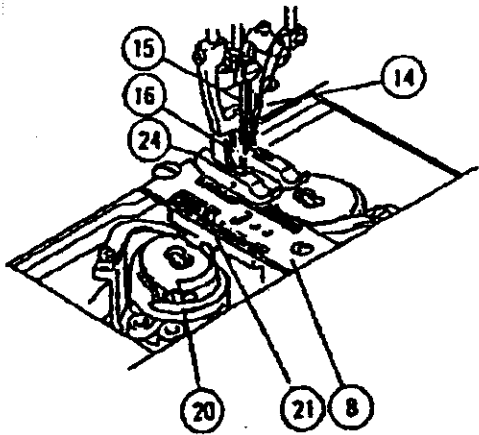

(1) Setting the stitching needles

(Caution) Be sure to turn off the power switch before trying the following procedure.

Turn the hand wheel toward you till the needle bar reaches its top dead point. Insert the two needles into the stitch needle clamp as far as they go, holding them so that their grooves face each other. Then fasten the screw. During the operation of the machine, there can exist a slight clearance between the properly fitted needle and the main needle groove, and the needle point is housed in the main needle groove completely.

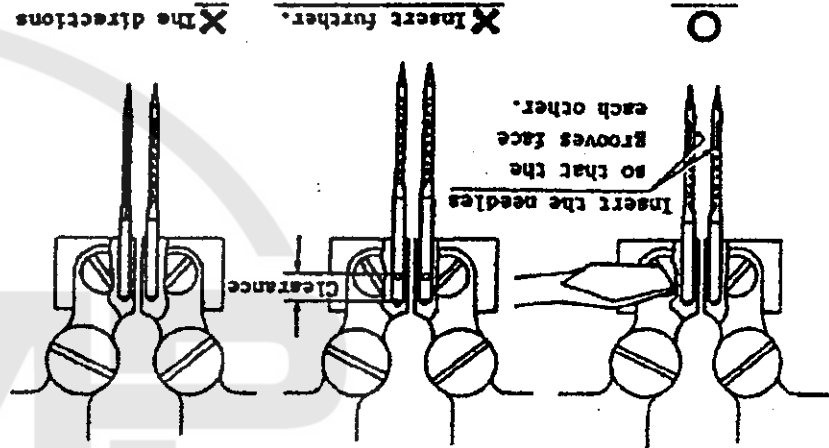

(2) Winding the under thread

(adjustment) \* Winding tension: Wind nylon and polyester thread very loosely.  
 \* Uneven bobbin winding: Move the tension thread guard in the direction that the quantity of thread wound is smaller.  
 \* Thread quantity to be wound: Loosen the regulating screw when a large quantity of thread is to be wound. And for a small quantity of thread, tighten the screw.

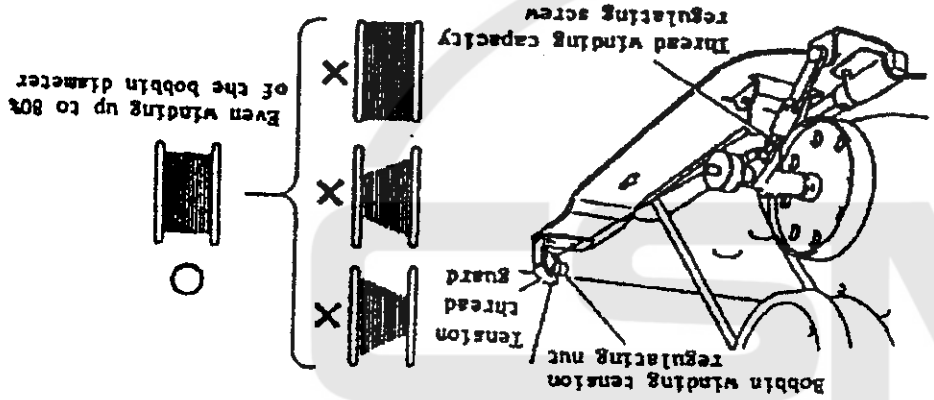

Turn the hand wheel toward you till the needle bar reaches its top dead point. Insert the two needles into the stitch needle clamp as far as they go, holding them so that their grooves face each other. Then fasten the screw. During the operation of the machine, there can exist a slight clearance between the properly fitted needle and the main needle groove, and the needle point is housed in the main needle groove completely.

(3) Threading the bobbin case

Thread the bobbin case as shown below.

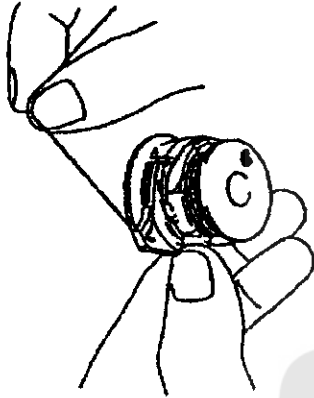

Attention) When viewed from the back, the bobbin should turn clockwise in the bobbin case if the under thread is pulled out.

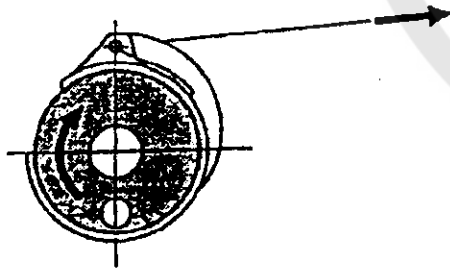

(4) Placing the bobbin case in the rotary hook

Draw about 5 cm of the thread out of the bobbin case. Hold the case as shown below and place it in the rotary hook.

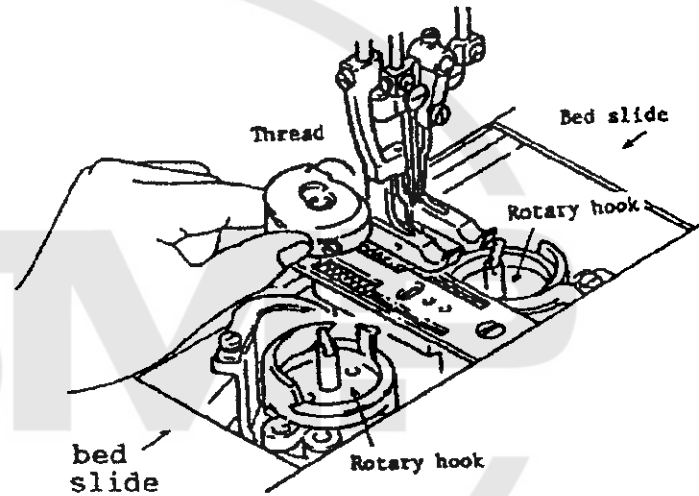

5) Upper threading of the machine

Attention) Each thread guide A of the spool holder should be placed right above each spool.

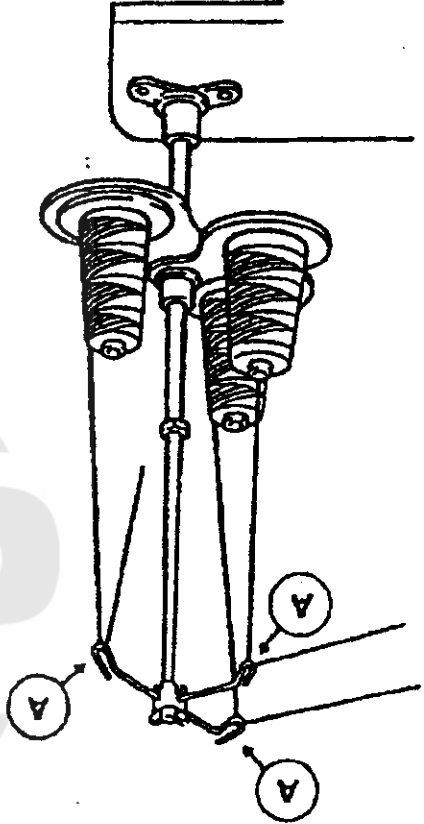

Position the take-up lever at the highest point and pass the thread in the order shown below.

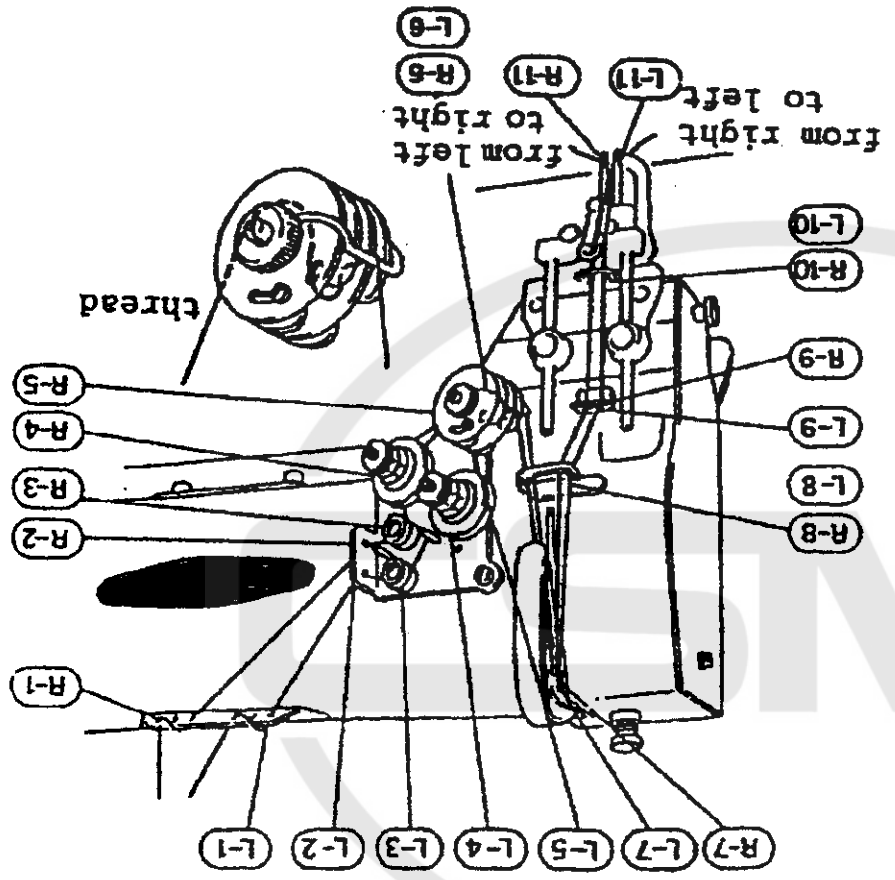

when enlarged

(6) Drawing up the under thread

Draw out the thread from the hole 1 of the bobbin case and stretch it on the bed. Hold the two upper threads between the thumb and forefinger of the left hand. And with the right hand, rotate the hand wheel once and draw the upper threads up as shown in the figure. And then, the under thread comes out.

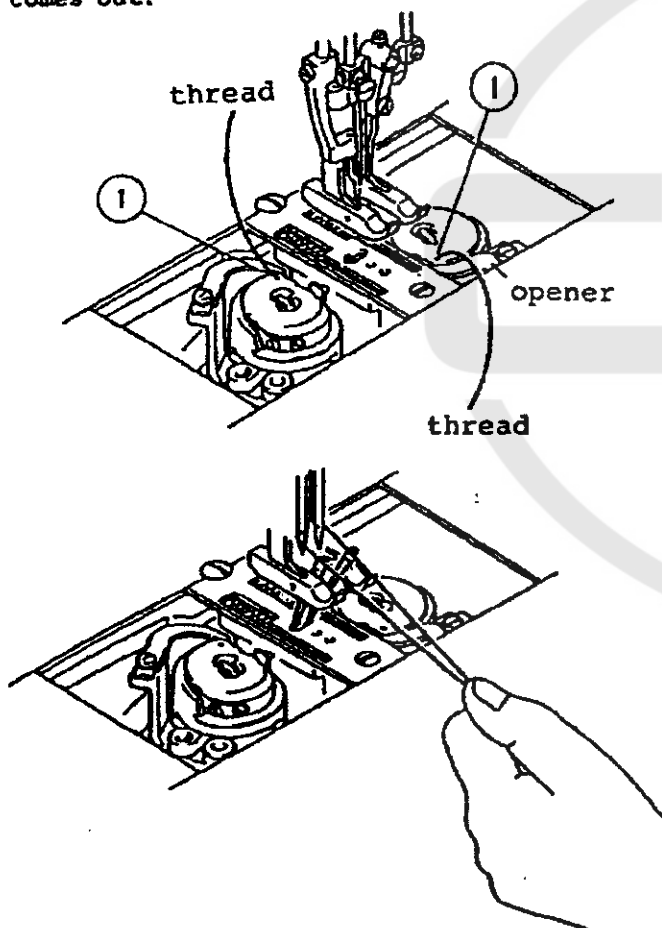

(7) Under thread tension

Tension of the under thread increases when the thread tension regulating screw is turned to the right while it decreases when the screw is turned to the left.

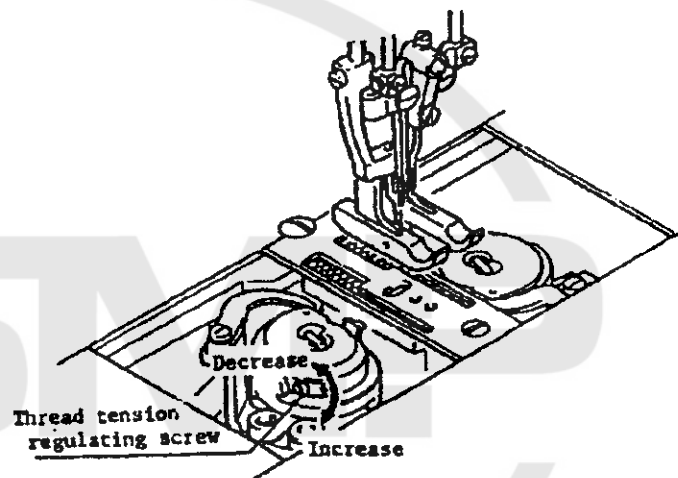

### (10) Adjusting the stitch length

Stitch length can be adjusted by loosening and sliding the hexagonal nut (1) located at the end of the feed rock rod. To increase the stitch length, slide the rod away from you, while to shorten the stitch length, slide it toward you. When the desirable length is obtained, tighten the hexagonal nut (1).

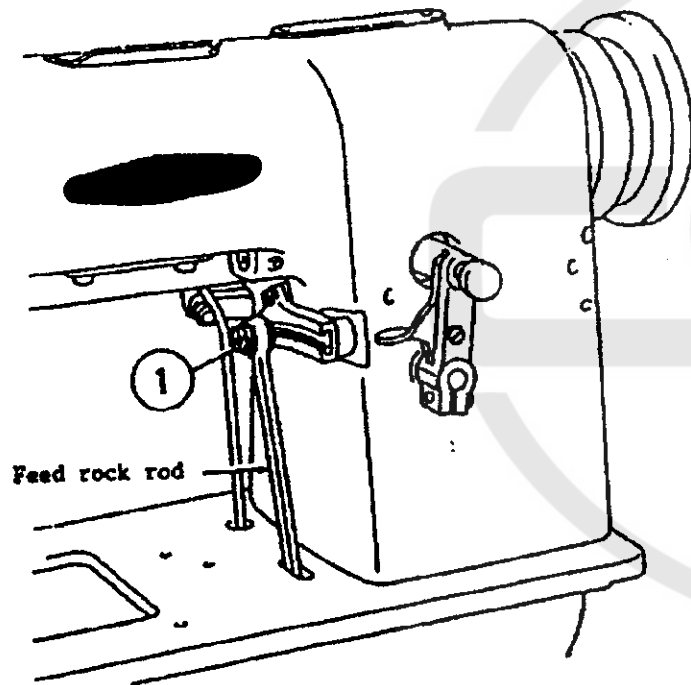

### (11) Setting the main needle

For replacing the main needle, loosen the main needle setscrew, remove the main needle from the main needle clamp and set a new one. Care should be taken to see that the stitching needle may be housed properly in the groove of the new main needle when it comes down. The position of the new main needle should be adjusted so that about 1.6 mm of its curved part appears above the throat plate.

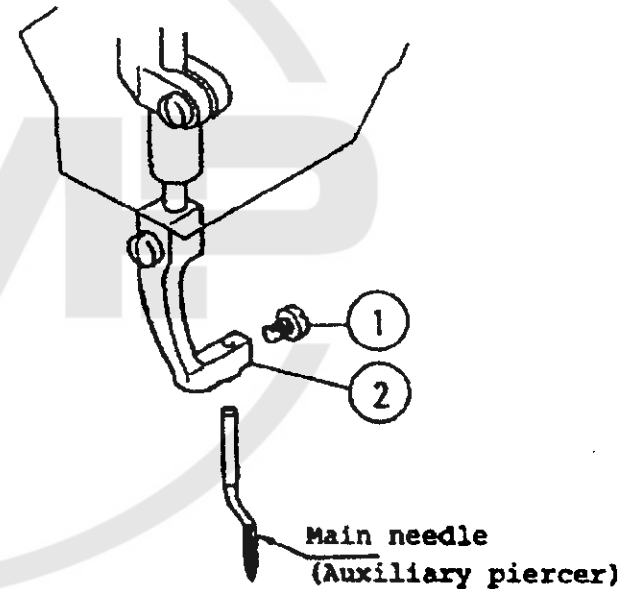



(12) Setting the guide needle (Piercer)

For replacing the guide needle, loosen the guide needle setscrew (1), remove the guide needle from the guide needle clamp and set a new one instead. To adjust the guide needle in accordance with the stitch length, loosen the setscrew (3) of the guide needle clamp (2), slide the holder front and rear to determine the proper traveling distance of the needle and securely tighten the setscrew (2).

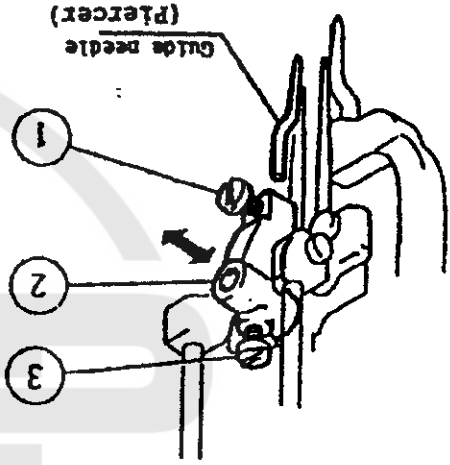

(13) Sewing a corner and a small circle

When the roulette nut on the presser foot actuating lever bracket is pressed inside, the presser foot is automatically raised at every third stitch so that the material can be easily turned. When a straight line is to be sewn again, press down the lever (3), and the presser foot lifting mechanism will be disengaged.

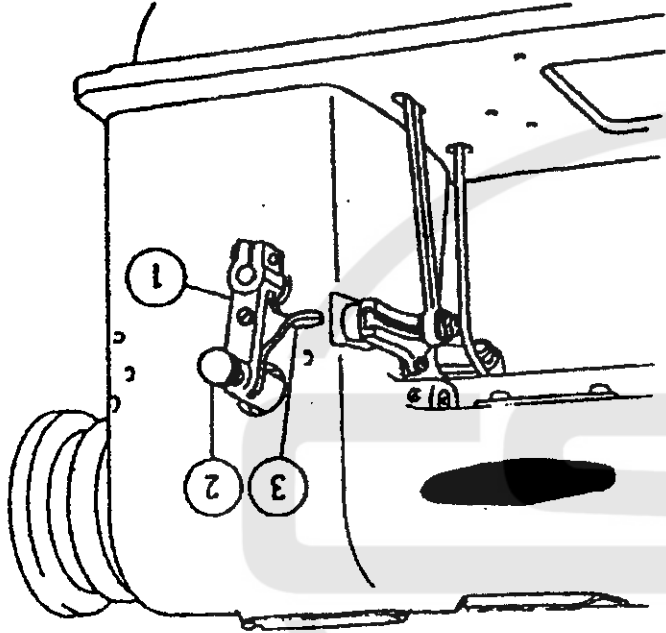

---

(14) Sewing a right-angle corner

When the main needle pierces the material to make the last hole of the straight stitch, raise the presser foot and turn the material before the stitching needles enter it. Then bring down the presser foot again, and proceed with the stitch.



3. Lubrication

Apply oil to the points indicated by the arrows in the drawings below. The lubrication should be done at least twice a day in order to keep the machine in the best condition.

(1) Points to be applied oil at the machine front

For the rotary hook, remove the bed slide and apply oil to its upper surface.

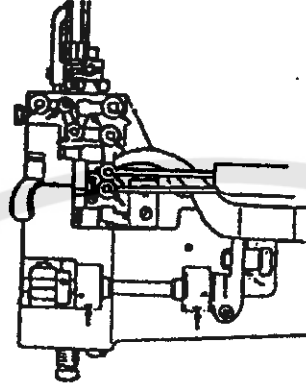
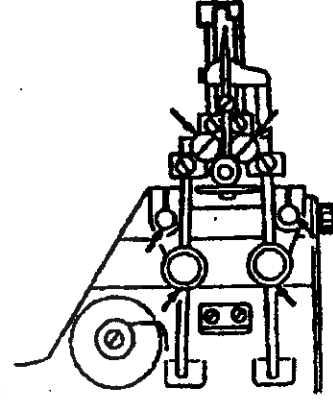
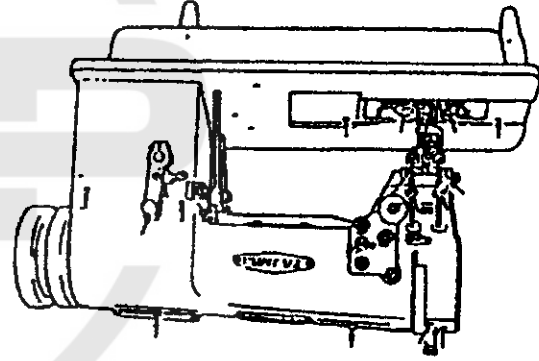

needle bar  
driving lever

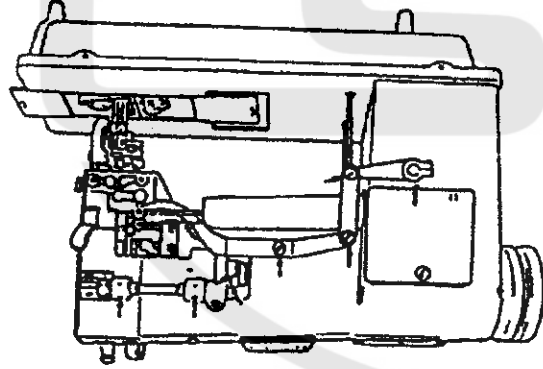

Remove the side cover when applying oil to the needle bar driving lever part.

(2) Points to be applied oil at the machine back

---

(3) Points to be applied oil at the left end of the machine

Remove the face plate, apply oil to all the movable parts inside and set the face plate back.

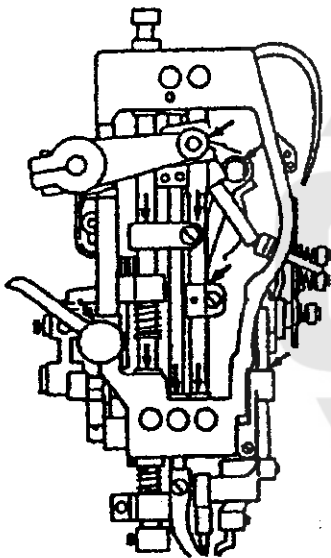

(4) Points to be applied oil at the machine bottom

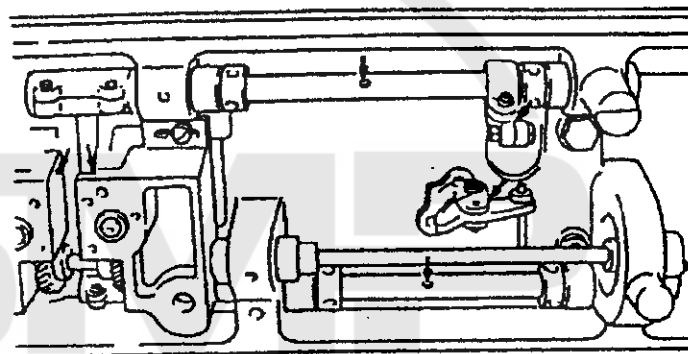



---

Material puckering becomes worse:

- (1) When the thread or the needles are too thick for the material.
- (2) Upper or under thread tension is too strong.

## 5. Machine head specification

---

1. Product name	HIGH-SPEED 2-NEEDLE PICOT SEWING MACHINE
2. Machine model	119-2
3. Stitching speed	2500 stitch/minute
4. Bed dimension	178 x 475 mm
5. Depth size	235 (effective 214) mm
6. Lubrication	Manual oiling
7. Stitch length	4.5 mm (max.)
8. Needle stroke	Stitching needle and guide needle 33.4 mm Main needle 16.5 mm
9. Presser foot lifting height	5 mm
10. Applicable needle	Stitching needle DF X M20 Guide needle PKG X 8 Main needle PKZ X 1
11. Applicable rotary hook	All-rotating horizontal type rotary hook 12 C



**Global Parts bv**  
H. Figeeweg 4B  
2031 BJ Haarlem  
tel: 023-5425312  
fax: 023-5423422  
e-mail: [globalparts@planet.nl](mailto:globalparts@planet.nl)

**Global International BV**  
H. Figeeweg 4  
2031 BJ Haarlem  
tel: 023-5319584  
fax: 023-5311022  
e-mail: [global@imca.net](mailto:global@imca.net)