

# ELECTRIC STEAM GENERATOR



*User's and  
Maintenance  
Manual*



**ENGLISH**



<i>Manufacturer</i>	GHIDINI BENVENUTO s.r.l.
<i>Product</i>	Boiler - <b>SIMBA</b>
<i>Year</i>	2010
<i>Certification</i>	<b>CE</b>

## CONTENTS

1	INTRODUCTION	10	HAZARDOUS USE
2	GENERAL DESCRIPTION	11	DIMENSIONS AND TECHNICAL DRAWINGS
3	MACHINE IDENTIFICATION	12	MAINTENANCE PROCEDURES
4	TECHNICAL FEATURES	13	DISPOSAL
5	MACHINE COMPONENTS	14	HOW TO ORDER SPARE PARTS
6	MACHINE UNPACKING AND INSTALLATION	15	HANDLING AND TRANSPORT
7	INSTRUCTIONS FOR USE	16	WARRANTY
8	TROUBLESHOOTING AND SOLVING	17	CONFORMITY DECLARATION
9	PRECAUTIONS		

## 1 INTRODUCTION

---

The present user's and maintenance manual refers to the electric steam generator "SIMBA". It is possible to receive the latest release from our Technical Commercial Department or by visiting our website [www.ghidini-gb.it](http://www.ghidini-gb.it). The present user's and maintenance manual contains important information for the operator's health safeguard and safety.

This manual has to be read and kept in a safe place, in order to be always at the operator's disposal in case of need. Ghidini s.r.l. cannot be held liable for any damage to things or injury to persons caused by improper use of the machine in contrast with these instructions.

Any possible modifications effected on the components of the machine or its different use without prior written authorization by Ghidini s.r.l., relieve the latter of injury to persons and / or damages to things, voiding any warranty bindings, as well.

## 2 GENERAL DESCRIPTION

---

The SIMBA boiler produces steam, and must be connected to external electric and water supplies to operate. This machine includes a visual water level control device. Its use is simple and efficient thanks to its front control panel.

## 3 MACHINE IDENTIFICATION

---

On the left side of the boiler, a metal rating plate quotes the model, serial number, the year of construction and electrical and pressure supply.

## 4 TECHNICAL FEATURES

---

TECHNICAL FEATURES	
Electrical power supply	230V – 1Ph – 50/60 Hz
Boiler capacity	5 L
Maximum steam pressure	2,8 bar
Boiler power supply	1450 W
Iron power supply	800 W
Sound pressure level	< 70 dB(A)
Operating temperature	+ 5 ÷ + 80 °C
Operating humidity	90 % max.
Storing temperature	-20 ÷ +50 °C
Dimensions	225 x 450 x 820 mm.
Net weight	18 Kg
Overall dimensions (with packing)	240 x 465 x 835 mm
Gross weight (with packing)	20 Kg

**WARNING:** Check that the supplied voltage and pressure correspond to that indicated in the table above.

## 5 MACHINE COMPONENTS

The main parts of the machine are as follows:

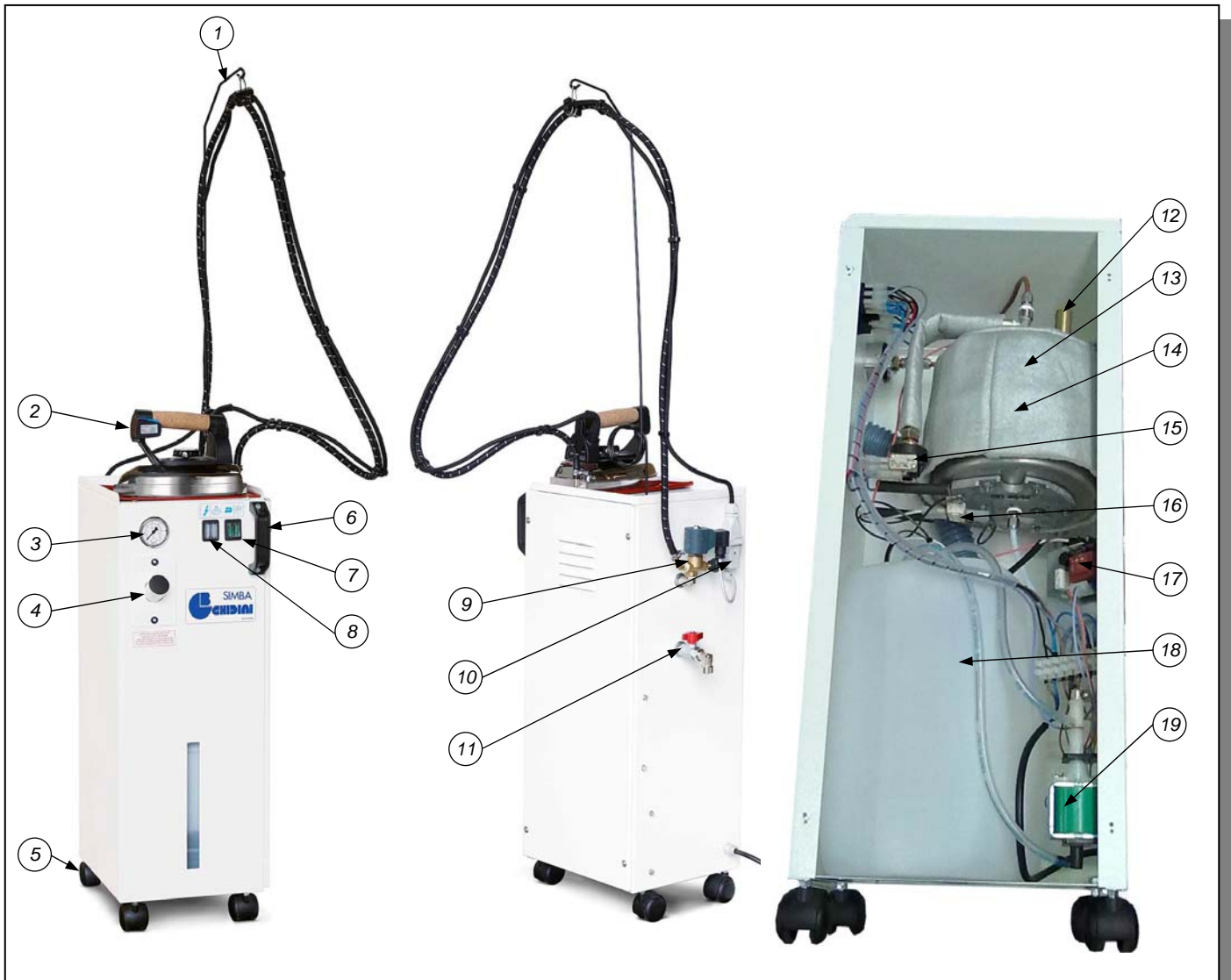

Pos.	CODE	DESCRIPTION	Pos.	CODE	DESCRIPTION
1	534252	Iron hose support	11	37A010	Boiler outlet gate valve
2	Z18D00	Iron model K	12	38S001	Safety valve
3	35A015	Gauge	13	224325	Boiler casing
4	22K050	Water tank cap	14	201011	Boiler
5	56B010	Swivelling wheels	15	45G012	Pressure switch
6	523260	Handle	16	45B018	Safety thermostat
7	43A014	Boiler and iron switch	17	25L043	Electronic board level
8	43A016	Double indicator	18	165037	Water tank
9	39B045	Steam valve 230V 50Hz	19	42B027	Water pump
10	43H006 + 431002	Iron plug			
	43I000 + 43G004	Iron socket			

Iron mod. K cod. Z18D00

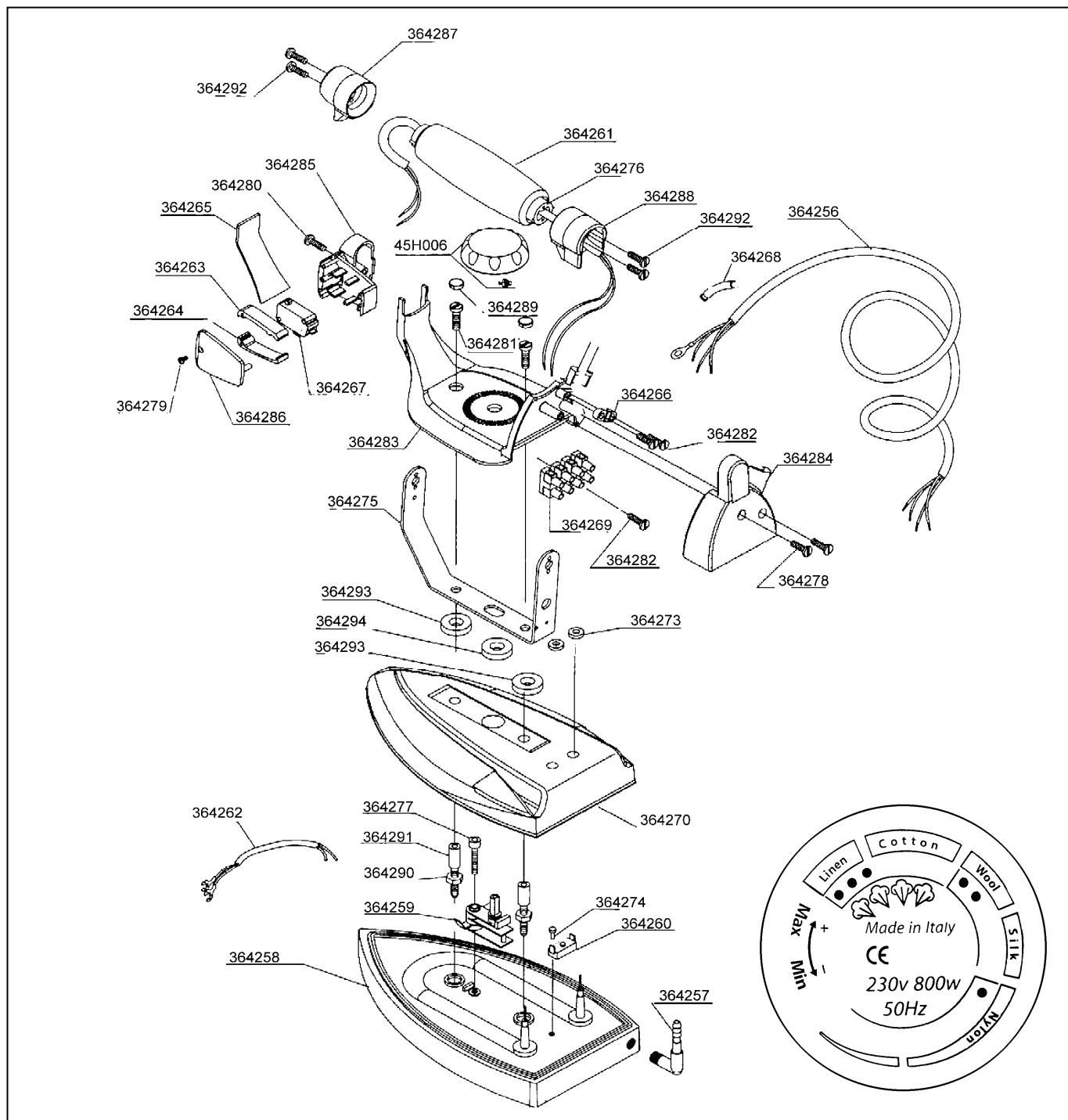

COD.	DESCRIPTION	COD.	DESCRIPTION	COD.	DESCRIPTION
364273	Cable lead for board heater	364278	Screw for back cover	364287	Front handle holder for iron
364256	Electrical cable for iron	364279	Screw for iron microswitch cover	364288	Rear handle holder for iron
364274	Screw for thermostat	364280	Screw for microswitch holder 3,5 x19 AU	364289	Screw covers for iron
364257	Nickel-plated brass hose holder	364281	Screw for handle fixing M5 x 10 ZNB	364290	Brass washer
364258	Complete iron plate	364282	Screw for terminal board fixing	364291	Brass spacers
364259	Adjustable thermostat	364283	Handle cover for iron	364267	Complete microswitch for iron
364260	Thermostat with manual reset	364284	Rear cover for iron	364292	Screw for iron handle
364261	Corkgrip	364285	Button holder for iron	45H006	Knob made of black bakelite
364275	Handle support for iron	364286	Button holder cover for iron	364293	Washer for screw
364270	Casing for iron	364263	Upper button for iron	364294	Washer for knob
364262	Cables for iron	364264	Lower button for iron	364268	Cable lead for electrical cable
364276	Insert for iron handle	364265	Plate for handle support	364269	Terminal board with 4 poles
364277	Screw M4 x 22 for thermostat fixing	364266	Cable holder for iron		

## 6 MACHINE UNPACKING AND INSTALLATION

---

**WARNING:** The unit must be installed, opened and repaired by fully qualified technicians only.

### 6.1 UNPACKING

Find the most suitable place where to put the machine, then remove it from the packaging and check that it is intact. The packing materials do not require special disposal as they are not dangerous or polluting. Refer to the local rules in force to discard them.

### 6.2 INSTALLATION

The machine does not need to be anchored to the floor, except for installation on self-moving vehicles, where it is necessary to use the holes on the base for the right attachment.

For correct use and operation, as well as for easy maintenance, leave a free space around the machine.

Do not put the machine in dangerous or flammable places.

### 6.3 ELECTRICAL CONNECTION

Electrical connection must be carried out as indicated in the technical drawings. Check that the supply voltage corresponds to that indicated on the rating plate. The dimensions of the feeding cable must be adequate to the machine absorption and in conformity with the laws in force. To ensure safe connection to the main supply, use a magnetothermal switch or otherwise a switch with fuses.

**WARNING:** At the end of the electrical connection, check that the cables are well fixed, isolated and protected from bumps.

## 7 INSTRUCTIONS FOR USE

---

### 7.1 OPERATION

- Installation and maintenance must be carried out by qualified technicians only.
- Do not use the machine plunged in fluids, or in dangerous or flammable places.
- Do not ignore the dangers to the operator's health and follow the hygienic and safety prescriptions.
- Always use piping suitable for operating pressures.
- Make sure that the electrical wiring is carried out correctly according to the current regulations, and that the fuse blocks are closed and complete of fuses.
- Check that the safety and control devices of the boiler (pressure gauge, pressure switch and safety valve) are intact.
- Make sure that the gate valve of the boiler exhaust is completely closed.
- Check that the electrical wiring and the piping of the iron are intact and secure.

### 7.2 USE

- Verify the water level in the tank and add more water if necessary.
- Turn on the main switch of the machine.
- The power supply light on the control panel is illuminated.
- Turn on the boiler and the iron.
- The water pump turns on automatically and water filters into the boiler.
- When the water reaches the correct level turn on the boiler power supply.
- The boiler reaches the operating pressure of 2.8 bar after a few minutes and the related light is illuminated automatically.
- The boiler is ready to supply steam.

## 8 TROUBLESHOOTING AND SOLVING

The following table shows the main problems and the corresponding causes and solutions. In case of doubts or unresolved problems, do not look for the trouble by removing pieces of the machine, but rather contact the Technical Office or seller of Ghidini products.

PROBLEMS AND SOLUTIONS		
PROBLEMS	POSSIBLE CAUSES	SOLUTIONS
The machine does not work.	Main power failure	<i>Check that the supply terminals are live.</i>
	Fuses are blown	<i>Check fuses.</i>
The power switch is on and the pump continues to fill water without stopping	Water doesn't enter into boiler	<i>Problems with the pump or clogged pipes.</i>
		<i>Check if the outlet gate valve is closed tightly.</i>
The heater light is always switched on and the boiler does not reach the requested working pressure.	Leak from the boiler outlet	<i>Check if the outlet gate valve is closed tightly.</i>
	Heaters are burnt out	<i>Verificare stato resistenze.</i>
	Absence of water in the boiler	<i>Refill the tank.</i>
	Boiler heaters are defective	<i>Check condition of heaters</i>

**WARNING:** If the safety valve is released, immediately turn off the boiler and consult a qualified technician. Do not cover vent and do not underestimate the problem, there is a risk of explosion.

## 9 PRECAUTIONS

Read carefully the instructions and the risks related to the use of a steam boiler. Operators must know operating system and clearly understand its dangers through the manual.

### **Main electrical supply**

Prior to carrying out any inspection or work on the machine, disconnect it from the main electrical supply and make sure that nobody can connect it again during the technical operations. All the electrical or electronic machines or basic structures installed must be connected to the ground line.

### **Flammability**

Adopt all the necessary precautions to avoid any direct contact with hot materials or flames. Put fire extinguishers near the machine for an immediate intervention in the event of fire.

### **Pressure / Steam**

Before each intervention switch off the boiler and check that residual pressures are not inside any branch of the hydraulic circuit. They could cause steam sprays in the case of disassembling of pipes or components.

### **Noise**

The noise emission is not excessive, because it remains under 70dB(A).

## 10 HAZARDOUS USE

The verification of conformity to the essential safety rules and to the dispositions enclosed in the machine directive is carried out by filling in the checking lists arranged in advance and included in the technical file.

The checking lists are of two kinds:

- List of dangers (extract from EN 1050 referring to EN 292).
- Application of the essential safety characteristics (Dir. Machine – encl. 1, part 1)

**The dangers described in the following items have not been completely eliminated, but they have been considered acceptable:**

- During the maintenance operation there could be some sprays of steam, at low pressure, or of spotting product (maintenance operation must be performed using suitable protection devices).
- During use it is possible to accidentally come into contact with surfaces at a temperature of over 80°C. Be careful.
- Protection against direct and indirect contact with steam must be ensured by the user.

## 11 DIMENSIONS AND TECHNICAL DRAWINGS

---



- |   |
|---|
| <ol style="list-style-type: none"><li>1. Water supply inlet</li><li>2. Control panel</li><li>3. Water level in water tank</li><li>4. Steam outlet</li><li>5. Boiler water outlet pipe</li><li>6. Power supply inlet</li></ol> |
|---|





## 12 MAINTENANCE PROCEDURES

---

In case of troubles, contact the technician for the inspection and, if necessary, for unscheduled maintenance.

**Periodically it is necessary to carry out the following procedures:**

OPERATIONS	HOURS OF WORK
Empty the boiler (*)	40

(\*): Empty the boiler periodically when it is at a pressure of 1,0 bar, in order to remove possible lime residue and impurities. When the machine is turned off, put the outlet pipe in a bucket, and open gradually the tap of the boiler outlet.

This machine does not require special equipment for check and maintenance operations, but use suitable tools and personal protection in compliance with D.Lgs. 626/94 and in good condition (DPR. 547/55) in order to avoid harm to people and to parts of the machine.

**Prior to carrying out any inspection or work on the machine, make sure that it is disconnected from the main electrical supply.**

## 13 DISPOSAL

---

During the maintenance operations, or in case of demolition, do not litter the environment with polluting elements. Refer to the local laws in force for appropriate disposal. In case of demolition, it is necessary to destroy the identification rating plate and any other document.

## 14 HOW TO ORDER SPARE PARTS

---

For the spare parts request it is necessary to quote the model of the machine, the serial number, the quantity of the spare parts requested and their code number. (This data is available on the rating plate, the technical data and on the operating instructions.)

If the voltage and frequency of the electrical parts to replace are not V220-380/50Hz (check these particular characteristics on the rating plate of the part to replace), quote the right data.

The technical data, the descriptions and pictures included in this manual are not binding. The manufacturer reserves the right to make any necessary modification without notice and without updating these operating instructions.

## 15 HANDLING AND TRANSPORT

---

Before its transport the machine is carefully packed in a wooden cage. During the transport and the stocking operations, pay attention to warnings printed on the packaging. At the moment of the delivery, check that the packing is intact and put the machine in a dry place.

## 16 WARRANTY

---

All Ghidini products are supplied with a guarantee for materials and manufacturing failures for a period of maximum 12 months from the date of the delivery.

**The guarantee is extended as follows:**

In case of malfunction of the machinery contact Ghidini and quote the trouble, the model, serial number and the operating conditions of the machine. Upon receipt of the machine and after an accurate analysis, Ghidini reserves the right to repair or to replace the product. If the machine is still under guarantee, Ghidini will repair or replace it free of charge, but if the returned product is not defective, Ghidini reserves the right to charge the freight to the customer (transport, etc.).

This warranty must be considered annulled in case of damages caused by incorrect use, negligence, wear and tear, chemical corrosion, installation contrary to the operating instructions supplied by Ghidini. Any eventual modification or different use of the machine must be previously authorized by Ghidini through a written document, otherwise Ghidini may be considered free even from the guarantee bond.

The parts of the machine which are subjected to wear and tear are not included in the guarantee as well as all the items not explicitly cited, or damages and expenses caused by the defects of the product itself. Implicitly the customer accepts the conditions of the present warranty upon purchasing the machine. Eventual modifications to the guarantee must be authorized by Ghidini through a written document.

# 17 CONFORMITY CERTIFICATE

---

<b>Manufacturer:</b>	<u>GHIDINI</u> Company
	<u>Via Tolstoj, 24 – 20098 S. Giuliano Milanese (MI)</u> Address
	<u>+39 -02 -98.24.06.00</u> Phone number

**Certifies that:**

<b>The machine:</b>	<u>Boiler - <b>SIMBA</b></u>
---------------------	------------------------------

- \* is built in conformity with the DIRECTIVES OF THE EUROPEAN COMMUNITY COUNCIL referring to machines ( 98/37/CE) and to low-tension (BT 73/23/CEE) and PED certificate (97/23/CE).
- \* is built in conformity with the following laws and technical specifications, in what can be applied and in mutual agreement: EN 292-1/2, EN 1050, EN 982, EN 11200, EN 60947, EN 894-1/2.

---

Managing Director	Roland Fleischmann
Product Manager	Name

---

GHIDINI S.R.L.
Company

---

	September 2010
Signature	Date



Web site: <http://www.ghidini-gb.it> - E-mail: [sales@ghidini-gb.it](mailto:sales@ghidini-gb.it)